



Michael Carpenter  
Director of Bands  
317.839.7711 ext. 1117  
[mcarpenter@plainfield.k12.in.us](mailto:mcarpenter@plainfield.k12.in.us)

**Plainfield**  
B A N D S

Melissa Sedwick  
Contest Coordinator  
317.966.8605  
[volunteers@plainfieldband.org](mailto:volunteers@plainfieldband.org)

## IHSCGA Red Pride Winter Guard Invitational

Contest Information  
Saturday, January 25, 2020

### **GUARD CHECK-IN:**

Enter through the North Entrance at Door 21. Doors will be open at 8:30am. The director of each unit must check in and complete their declaration form at the guard entrance before allowing students to get off the bus. If you have not completed an announcer/spiel sheet online, you will be asked to do that at this time. You will also sign up for critique at this time. All participants, prop help, and chaperones must enter the building through Door 21. As per IHSCGA procedures, each guard unit receives 2 passes for their bus and equipment drivers and 8 additional tickets for prop people, chaperones, staff, etc., in addition to your declared number of performers. Wristbands will be used.

We can still get your spiel information in our program if you submit it by January 18<sup>th</sup>.

Additional prop people, chaperones, etc. will be charged \$3.00 for students and \$6.00 for adults at this entrance. ALL Adults paying the full admission price at check-in will be issued a spectator wristband. Truck and Bus Drivers will receive a wristband that will allow them access to the spectator seating.

The contest schedule can be found on [www.ihscga.org](http://www.ihscga.org).

### **BUS/TRUCK PARKING:**

Busses will park on the NORTH side of the school. Look for the band tower.

### **DIRECTOR PARKING:**

Director parking is on the EAST side of the school near the main entrance (door 1).

### **GENERAL SPECTATOR ADMISSION:**

All spectators will park in the South parking lot near the bell tower/stadium. Doors will open at 9:00AM. All spectators will enter the building through the doors located on the SOUTH side of the building at Door 7 near the bell tower. Admission price is \$7.00 for spectators. Children 5 and under are \$3, infant in lap is free.

### **HOMEROOMS:**

Homeroom areas will be in hallways. Please do not leave valuables in the homerooms area. Changing areas will be provided. See Map.

### **GYM/TIMELINE/WARM-UP:**

Please see the map below.

The Warm-up area will be held in our field house that split into an A and B warm up location. The goals will be up. Groups will be allowed to use music during the second half of their warm-up time per IHSCGA guidelines.

There will be a HORIZONTAL timeline utilized for this contest. Entrance to the competition floor will be from the back left as you look at floor from the spectator side and exit will be on the front left.

### **HOSPITALITY ROOM:**

This will be located in the lobby of our auditorium located just inside door 1. Directors, instructors, and drivers only with IHSCGA credentials please.

### **PROPS AND EQUIPMENT:**

Props will enter the building through Door 21. This is the same door as check-in. This entrance will have 3 sets of double doors with the posts removed for larger props. No one will be allowed to enter the building without a wristband or pass, so please communicate this with your volunteers. The prop loading area will begin in the large hallway that goes throughout the length of the school into a small section of the cafeteria. Please plan to load your equipment immediately following your performance. All props must pass inspection in compliance with IHSCGA rules. Props that are not in compliance will not be permitted in the gym until they pass inspection. Please make sure your props and equipment have rubber tips and padding. If something doesn't pass inspection, we will try to tape what we can. If we cannot ensure that our gym will not be damaged from props or equipment, it will not be allowed in the gym.

### **RECAPS/SHEETS/PACKETS/CRITIQUE:**

You must sign up for critique before the contest through your CompetitionSuite account. Critique with the Overview Judge will begin at 2:40pm for Cadet, Festival, and RA Rounds 1 & 2. Critique for groups in RA Round 3, A, Open, and World will begin 15 minutes after the last guard has performed. Director packets will be available in Director Hospitality as soon as possible after your awards ceremony

**LOADING AND PROP EXIT:** The prop loading area will begin in the large hallway that goes throughout the length of the school. Please plan to load your equipment immediately following your performance.

**AWARDS:** Cadet/Festival and Regional A Rounds 1 & 2 awards will be in the gym immediately following the last performance of Regional A Round 2 at 2:40pm. Awards for Regional A Round 3, A, Open, and World will happen after the last guard has performed. Make sure that your representatives meet prior to awards in the hallway nearest the guard entrance to the gym.

**CONTEST HEADQUARTERS:** The Library/Media Center will be utilized as contest headquarters. In the event that a host is not in the media center there will be a contest volunteer that will have access to a radio to contact one of the hosts if needed.

**EMERGENCY PHONE NUMBERS:** Please contact Mike Carpenter at 317.439.1286 or Melissa Sedwick at 317.966.8605. Cell reception is not great in the building, so please leave a message or text.

**EXITING THE BUILDING:** When leaving with your group, please do not have your busses move around to door 21 to pick up your students as doing this will cause major traffic problems with groups who are still trying to check in. Please have the students walk to their busses.

# Contest Site: Plainfield High School 1 Red Pride Drive Plainfield, IN 46168

## Emergency Contact Numbers:

**Michael Carpenter 317.439.1286 Call or Text**

**Melissa Sedwick 317.966.8605 Call or Text**

**PHS Band Office 317.839.2578 ext. 1117**

- **From North** take I-465 West to I-70 West. Take exit 66 to IN-267 North. Turn left at the second stop light onto Reeves Road.
- **From South** take I-465 West to I-70 West. Take exit 66 to IN-267 North. Turn left at the second stop light onto Reeves Road
- **From East** take I-70 West. Take exit 66 to IN-267 North. Turn left at the second stop light onto Reeves Road
- **From West** take I-70 East. Take exit 66 to IN-267 North. Turn left at the second stop light onto Reeves Road

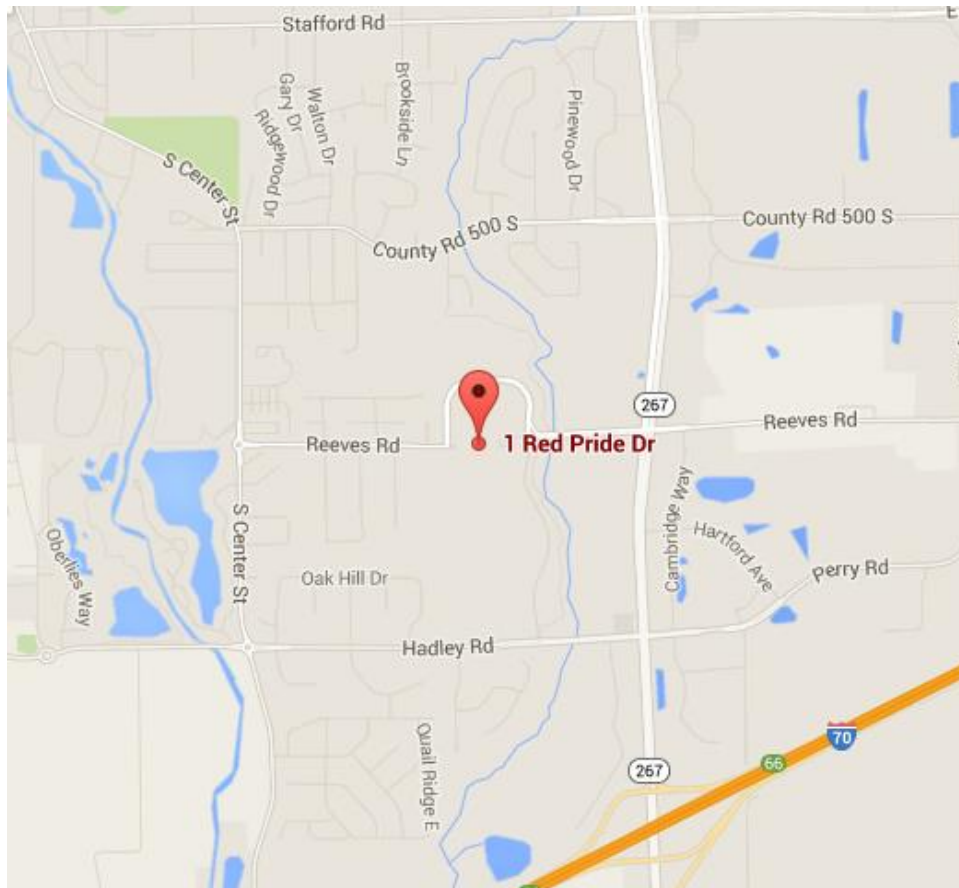

**Spectator  
Parking**

**Spectator Entrance  
Door 7**

**IHSCGA Plainfield  
Red Pride Winter Guard  
Invitational**

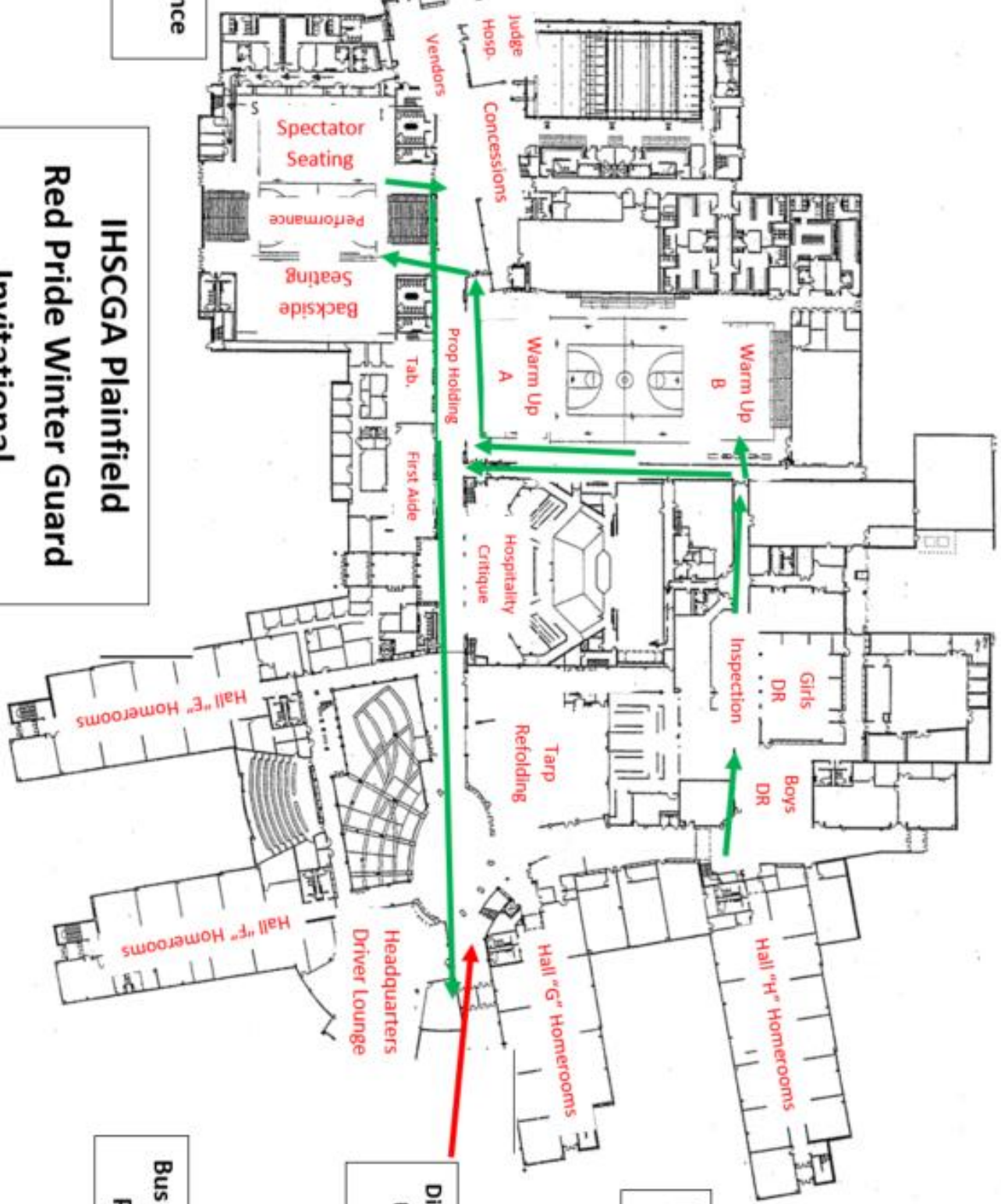

**Bus and Truck  
Parking**

**Director Check-In  
Door 21**

**Bus and Truck  
Parking**

# Performance Gym Layout

