



# Decatur Central High School

## IHSCGA Contest \* March 20, 2021

**LOCATION OF CONTEST:** 5251 Kentucky Avenue Indianapolis, IN 46221

Welcome to Decatur Central High School! We are very excited to host a contest for the IHSCGA. This is a great event to showcase the talent we have in Indiana. We hope that your time here will be a rewarding and educational experience for your students, staff, and fans. Please take a few moments to familiarize yourself with the high school map, flow of the contest, and other information in the packet. Thank you for helping us to keep everything looking new.

PLEASE NOTE: For the safety of all students, spectators, volunteers, and staff members, IHSCGA has made the following policy changes for live competitions:

- Masks must be worn at all times, inside or outside, while on the Decatur Central High School campus.
- Groups must arrive in performance attire. Changing Rooms will not be available.
- Groups may only enter the building with items related to their performance and any items necessary to assist with medical concerns.
- Groups are not permitted to enter the building until 30 minutes prior to warm-up.
- Groups may not warm-up in the building prior to their scheduled warm-up time.
- Groups must depart the show site immediately following their performance.
- Groups may not assist other groups with props, tarps, and/or equipment.
- Staff Hospitality, Driver Hospitality, Homeroom Hallways, and Changing Rooms have been removed for 2021.
- **NO FOOD may be brought into the school.**

**Host:** Tim Cox (DCHS Director of Bands). All contest workers will be wearing name badges and many of us will have walkie talkies/cell phones. Please let us know how we can help you during your time in Indianapolis.

**Phone Numbers:** High School Band Office: 317-856-5288  
ext 27200 (Tim Cox) Tim Cox Cell Phone: 317-506-1101

**ADMISSION PRICES:** We are selling tickets to our show ONLINE ONLY for \$7. This will allow for more safety and a cashless experience. We ask that only 4 ticket PER STUDENTS be purchased.

**LIVE STREAM :** We will be selling tickets to a live stream event that will run the entire day For one fee of \$10.00 plus an additional small fee be added to each ticket so that we can use the website.

**\$7 /Adults - there is an additional small fee to be added to each ticket so that we can use the website.**

**LINK TO ORDER TICKETS OR VIEW ON LIVE STREAM**

<http://dchstheatre.booktix.com/>

**TO GO MEAL AFTER YOUR PERFORMANCE:** We will be offering a MEAL for the students/parents in your group. This will be a BOX meal that you can grab and go (thus preventing the need to stop at a fast food place with your group. Please fill out this google form to order and be prepared to PAY when you pick the food (or at check in).

<https://forms.gle/iYMgjQMYwW4poZUe9>

**Guard Check-in:** Please check in at the Unit Check-In table at the MAIN Entrance of the high school (DOOR #1). All participants, prop helpers, and staff should check in together. Please remember that you are allowed the # of performing members per your declaration sheet and up to eight (8) tickets for additional helpers (student or adult). Performers will NOT receive a wristband. A maximum of two (2) complimentary passes will be issued for your drivers. All others must be paid for at this time.

**BUS PARKING / Equipment Trucks** Buses will park near doors 12/13 / 14 - 15 / 16 (Which is the side of the Building where our Football Stadium is. There is also an additional parking lot near the back side of our stadium for trucks and buses. **PLEASE DO NOT PULL UP TO DOOR #10 TO LOAD after your performance if at all possible.**

**Director Parking will be at door #1 (Guard Check in)**

**Equipment/Prop Check-in:** After check-in, you will be able to unload your equipment at the equipment/prop entrance located on the south side of the school (SEE MAP). This is also building **DOOR #10**. We want to have as much room as possible for everyone to unload so we ask that EVERYONE UNLOAD QUICKLY and MOVE your equipment truck away from DOOR #10. Everyone going through these doors MUST have a wristband! You can move your equipment in early, as we will be storing you in the main hallway. We must go in performance order, so you will be given a number that assigns you to your position.

**Homerooms:** We will **NOT** provide designated / assigned hallway space and common changing rooms. **NO GLITTER is to be used in the building.**

**Restrooms:** There will be restrooms available throughout the building– please see the map.

**Videos:** Will be available via competition suite like the regular season shows. There is no charge for this as it was included in your contest fee for this event. Parents are allowed to videotape, but are permitted to record only their own group.

**Awards:** via Facebook / IHSCGA Youtube Channel on Sunday at 6pm

**Concessions:** Our band boosters do an outstanding job in this area. We will run a limited amount of food but encourage you to visit as you enter.

**Warm-up:** We will run 2 warm-up areas, one in our East Gym and the other in our high school Band Room. Both areas are over 60' x 90' and will allow enough height. You will have the interval time allowed for your class. \*Please see the new protocol for warm up.

**Performance:** The performance area will be 100' x 65'. We will have the floor covered with the protective tarp (black). The boundary line and timing lines will be clearly marked. The floor will be set back off the front side line of the gym floor approximately 3 ft. We suggest that you only move your floor back a few inches from where the black tarp begins. REMEMBER that we here at Decatur Central use a less than 1/4" floor mat (PLUS our black tarp) that is put down for the protection of the gym floor. The size of the floor mat is approximately 60' x 85' feet.

**Timeline/ Exit line:** The total performance time will stop once a group crosses the half way line from front

to back entirely. You will be exiting out the opposite doors in which you entered the gym to perform. See Performance floor flow chart enclosed.

We are looking forward to a great day of pageantry of the arts!

## DECATUR CENTRAL COLOR GUARD SHOW BUS AND TRUCK DRIVER INFO

**BUS DRIVERS:** **BUS PARKING / Equipment Trucks** PLEASE DROP ALL GUARD MEMBERS OFF AT DOOR #1 USING OUR CIRCLE DRIVE THEN GO BACK TO THE MAIN ENTRANCE to park near doors 12/13 / 14 - 15 / 16 (Which is the side of the Building where our Football Stadium is). There is also an additional parking lot near the back side of our stadium for trucks and buses.

**PROP TRUCK DRIVERS:** ENTER DCHS from KENTUCKY AVE and PROCEED TO DOOR #10 TO UNLOAD!!! THEN park near doors 12/13 / 14 - 15 / 16 (Which is the side of the Building where our Football Stadium is). There is also an additional parking lot near the back side of our stadium for trucks and buses. **PLEASE DO NOT PULL UP TO DOOR #10 TO LOAD after your performance if at all possible.** GENERAL INFO FOR ALL DRIVERS: Everyone will need a wristband or lanyard from the IHSCGA for admission to the gym.

## DECATUR CENTRAL COLOR GUARD SHOW FAN / PARENT INFORMATION

**ADDRESS:** 5251 KENTUCKY AVENUE, INDIANAPOLIS, IN 46221 **PHONE:**  
317-856-5288

**SPECTATOR PARKING:** **PLEASE ENTER CAMPUS FROM KENTUCKY AVE.** (Hwy 67) and following the signs and directions of our band parents. One side of the building will be Buses and Trucks and the other side will be for spectators.

**SPECTATOR ENTRANCE:** DOOR #29 / Cafeteria Entrance

**WRISTBANDS:** We will issue wristbands to your 8 helpers + 2 Drivers (10 total)

**PRICES:** Adults \$7 Students/Seniors \$5.00 Children 5 and under \$3.00 These prices are set by the IHSCGA and not Decatur Central HS.

**NO FOOD / COOLERS may be brought into the school.**

**This is a non smoking facility**

**MAPS ON THE  
FOLLOWING  
PAGES**

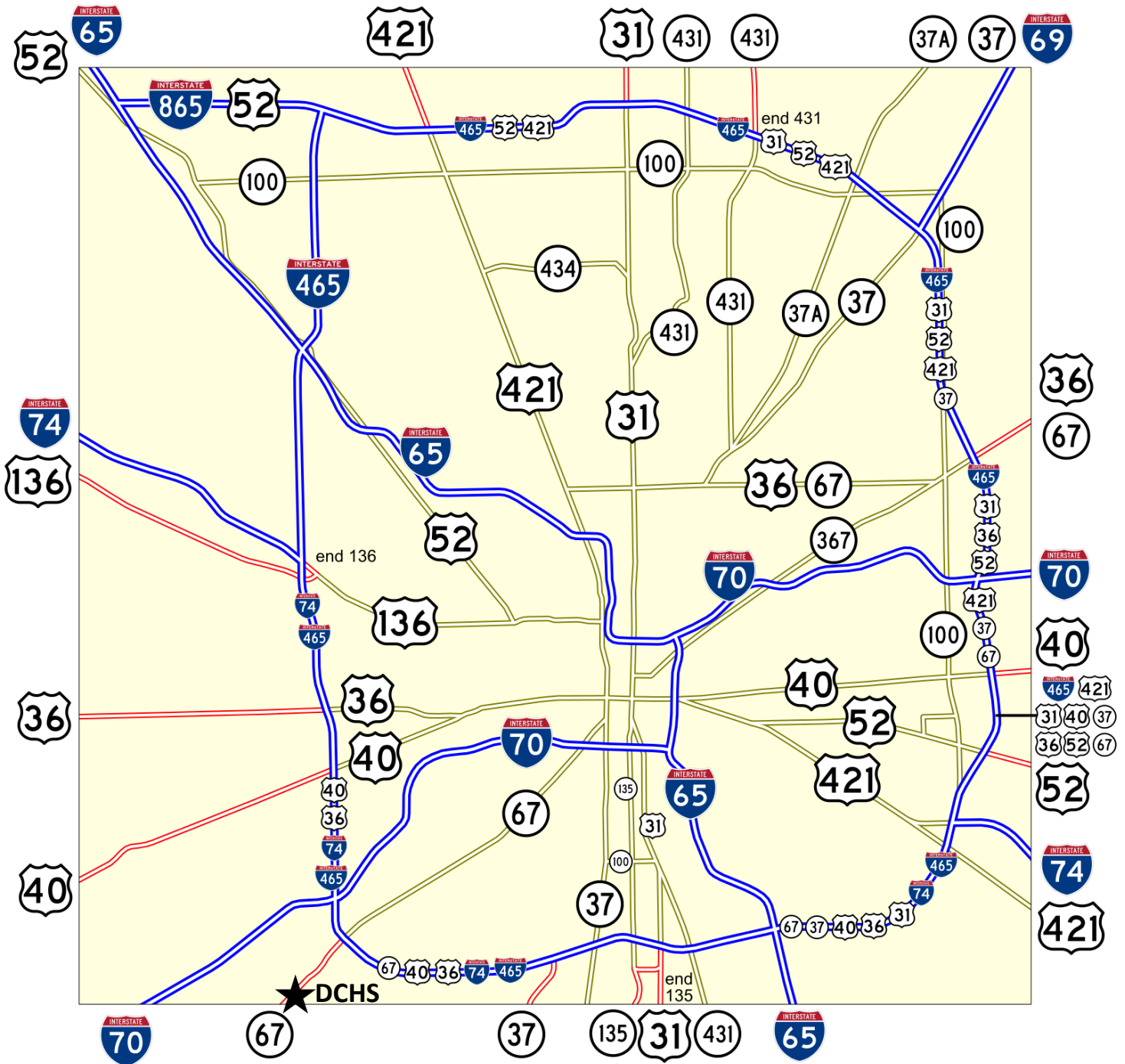

**ADDRESS: DECATUR CENTRAL HIGH SCHOOL**  
 5251 Kentucky Avenue, Indianapolis, IN 46221

**DIRECTIONS:**

FROM THE NORTH, EAST, or WEST: I-465 South to Exit 8: Kentucky Ave. (IN-67)  
 FROM THE SOUTH: I-465 West to Exit 8: Kentucky Ave. (IN-67)

Turn left (southwest) toward Mooresville. Travel approximately 1.3 miles.  
 The school will be on your left.



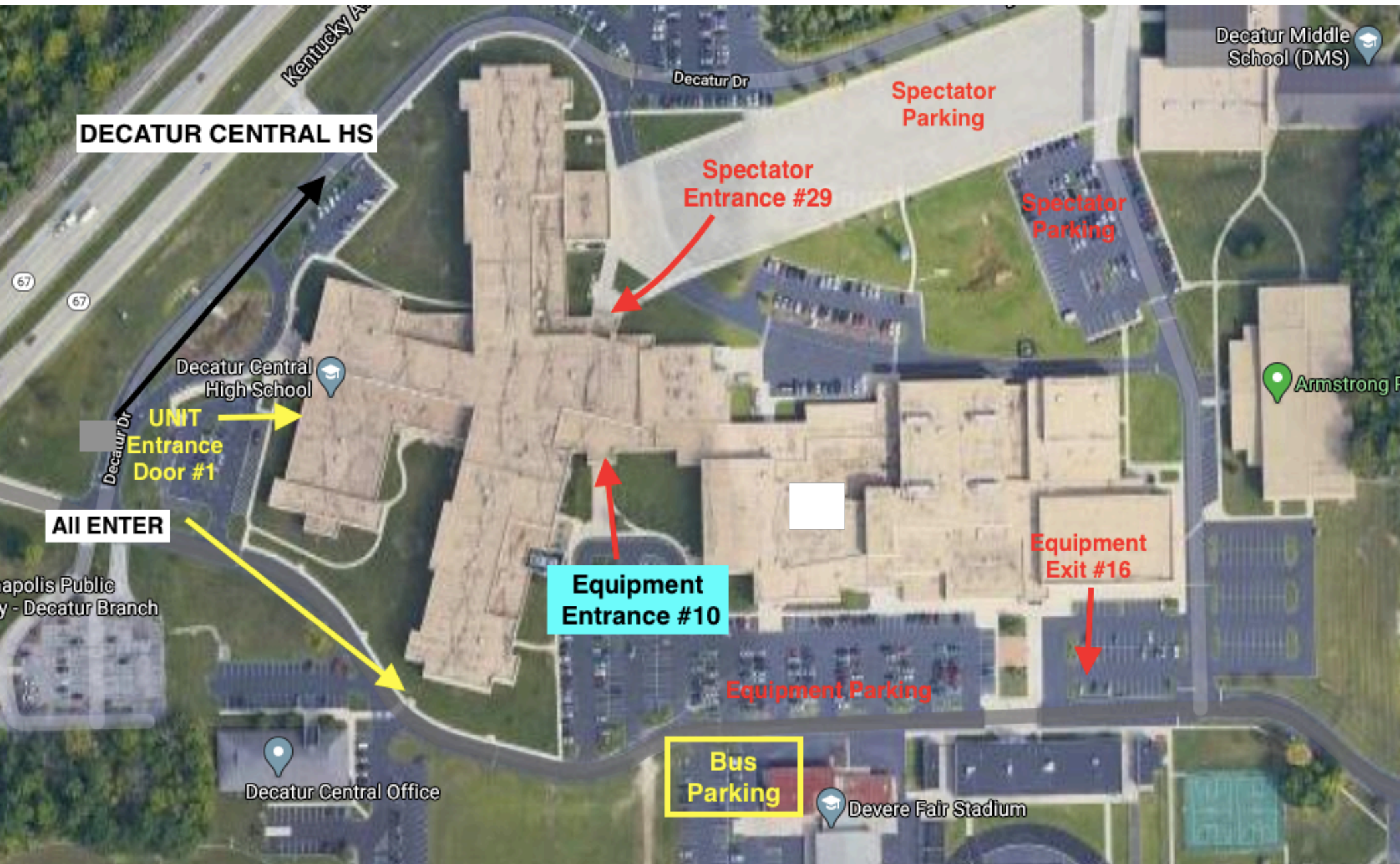

**DECATUR CENTRAL HS**

Decatur Middle School (DMS)

Spectator Parking

Spectator Entrance #29

Spectator Parking

Decatur Central High School

Armstrong F

UNIT Entrance Door #1

All ENTER

Equipment Exit #16

Equipment Entrance #10

Equipment Parking

Bus Parking

Devere Fair Stadium

Decatur Central Office

Decatur Public Library - Decatur Branch

Decatur  
Central  
High  
School

Warm up  
A

Equipment  
and Unit Exit  
#16

Spectator/  
Judges

MAIN GYM

Spectator Parking

Warm  
up B

Bus and  
Truck  
Parking

Spectator  
Entrance #29

Equipment  
Enter #10

Pictures

Unit Entrance #1

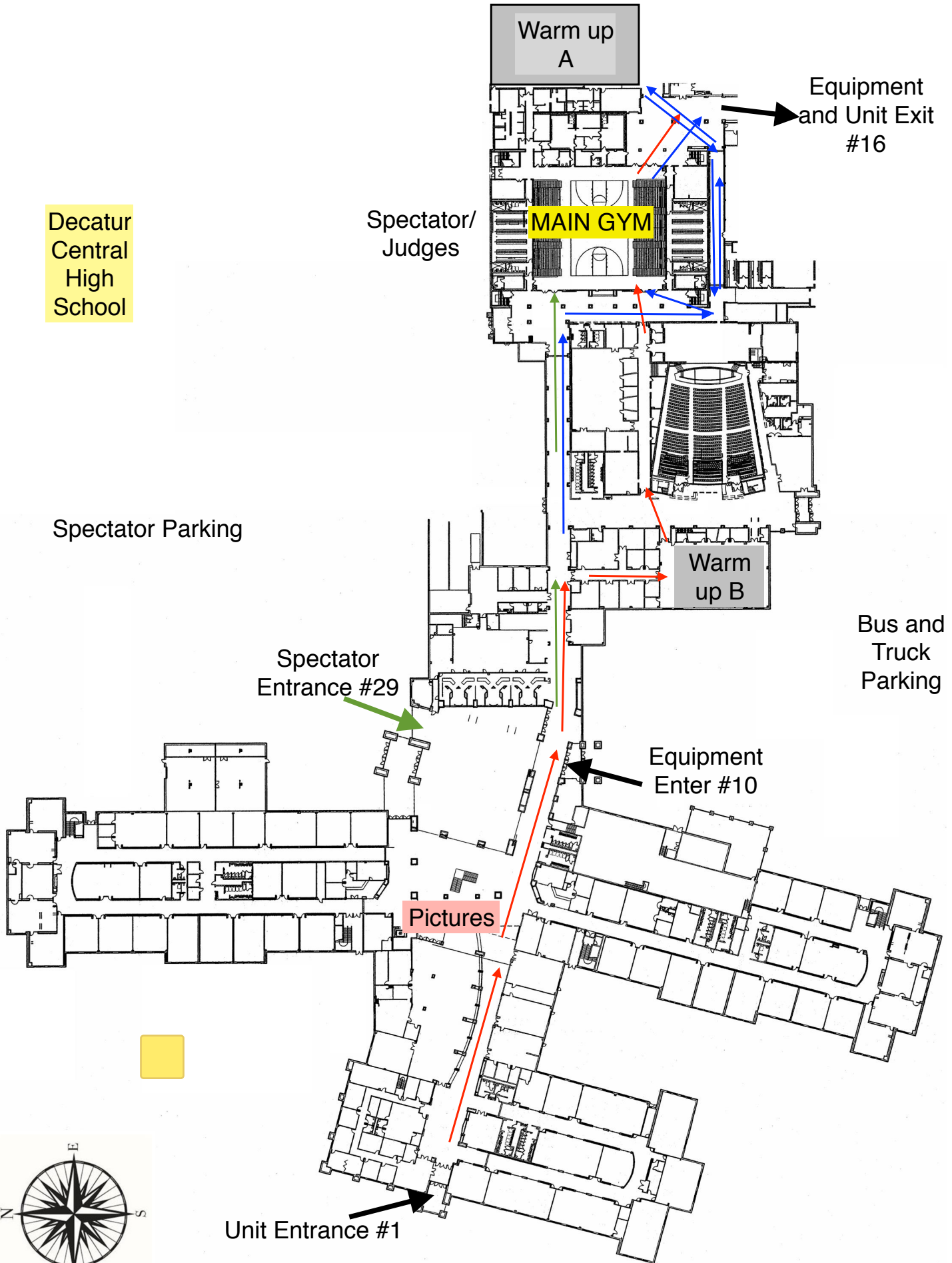
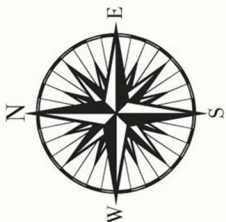



# DCHS Gym Map – Winter Guard Contest 2021

## Judges / Spectators

