

IHSCGA Invitational Greenwood Community High School

Saturday, March 20, 2021

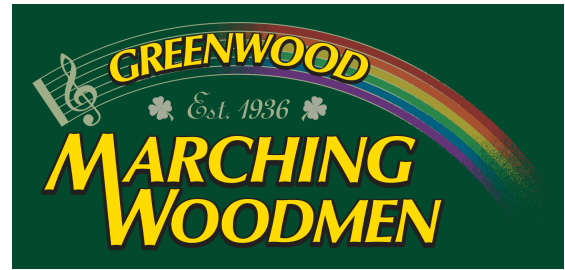

IMPORTANT - Share with your parents, fans, and drivers:

Our Mapquest/GPS Address is: **615 West Smith Valley Road Greenwood, Indiana 46142**

For the safety of all students, spectators, volunteers, and staff members, IHSCGA has made the following policy changes for live competitions:

- Masks must be worn at all times, inside or outside, while on the Greenwood High School campus. Performers are also required to wear masks during their performance.
- Groups must arrive in performance attire. Changing Rooms will not be available.
- Groups may only enter the building with items related to their performance and any items necessary to assist with medical concerns.
- Groups are not permitted to enter the building until **20 minutes** prior to warm-up.
- Groups may not warm-up in the building prior to their scheduled warm-up time.
- Groups must depart the show site immediately following their performance.
- Groups may not assist other groups with props, tarps, and/or equipment.
- Staff Hospitality, Driver Hospitality, Homeroom Hallways, and Changing Rooms have been removed for 2021.
- Inspection has been removed from the “pre-show” route for 2021. We will provide stoppers and tape for any emergencies on a table in the warm-up gym.
- As of this writing, spectators will be limited to 2 tickets per performing members. Greenwood High School will reach out to directors the week of the event if we can increase capacity.
- Backside seating will not be available at Greenwood.

Exceptions to these policies will not be made

No food or drink may be brought into the building. No coolers will be allowed.
Concessions will not be available due to COVID-19. Please plan accordingly.

GUARD CHECK-IN

Have your bus drop students at door #31N on the east side of the high school. Make sure the director of your unit is present to identify the 8 free wristbands for prop crew and check in.

BUS PARKING

Buses will be directed to park in the East lot in between the school and football stadium.

DIRECTOR PARKING

Director parking will be with buses in the East lot between the school and football stadium.

GENERAL SPECTATOR ADMISSION

- Spectator Parking- in the band practice area lot, north east of the school building close to the band tower.
- Spectator entrance- Door 2N (Main Entrance)
- Doors will open at 10:30 AM. Please do not arrive early.
- Admission is \$7 per person, children 5 and under are \$3, infant in lap is free.
- Credit/Debit Card will be the only accepted method of payment. Cash will not be accepted.
- Programs will be available electronically via QR code.
- Wristbands will be used. You will not be admitted to the gym without a wristband.
- Wristbands will be color-coded for each block of groups as separated by breaks.
- Wristbands will expire after each block during the break. After your child's block is done, we ask you to promptly leave the building so we can let the next block of spectators enter the gym.
- Spectators should not arrive more than 30 minutes before the start of their performer's "Block."

HOMEROOMS

Homerooms will not be utilized in 2021. Once groups are in the building, they will be held in the Auxiliary Gymnasium until they transit to warm-up, and restroom access will be available.

CONTACT INFORMATION

Contest Host-Ben Werne
812-639-9393 (cell)
317-889-4000 x3136 (office phone)
bwerne@gws.k12.in.us

Music Department Secretary-Lisa Knartzer
317-889-4000 x3407 (office)
317-889-4036 (fax)
lknartzer@gws.k12.in.us

GYM, TIMELINE, WARM-UP, ETC.

Please see the appropriate map. If you have any questions or need assistance, please do not hesitate to ask any of our workers.

Warm-Up Area: (Activity Center) The warm-up area will be in our activity center that is split into an A and B warm-up location. The basketball goals will be up. As communicated by IHSCGA, **Groups will be responsible for bringing their own speakers for warm-up music this year. IHSCGA will not be providing a Sound Cart for warm-up.** As always, groups will be allowed to use music during the second half of their warm up time per IHSCGA guidelines.

Performance Area: (Main Gym) Groups will enter through the NW corner of the gym (back right from audience view). The floor will be covered with a black tarp. We will utilize a vertical (sideline to sideline) timeline. Groups will exit the gym at the SE corner (front left from audience view)

PROPS

Equipment vehicles will be directed around the East side of the building to unload at door #31N. Once unloaded, vehicles will be asked to park on the South side of the main lot close to the activity center. Contest officials will direct your props/tarp to our staging area where they will process in performance order and meet your guard at the performance entrance in the Northwest corner of the gym. Please leave personnel with your props/tarp to move through the performance flow.

Upon exiting the gym after performance, there is a very long but narrow corridor for you to organize your equipment. Be prepared for a 90° left turn through this door.

Prop loading after performance will be at door #32E.

Door Dimensions

The narrowest path you will encounter will be 5 feet and 3 inches wide.

The shortest height you will encounter is 6 feet and 8 inches tall.

RECAPS / CRITIQUE / AWARDS

Recaps will be available via Competition Suite at the conclusion of the Virtual Awards Ceremony on Sunday. The link to the Virtual Awards will be provided by IHSCGA. Live awards ceremonies and Critique will not take place in 2021.

FIRST AID

First Aid is located in room J105. See attached map details.

BUS AND TRUCK DRIVER INFORMATION

Bus Drivers (Please see map provided.)

Follow signage to drop students at door #31N on the East side of the high school.

Buses will be directed to park in the east parking lot, which is between the school and the football stadium.

Due to COVID-19 restrictions, there will not be a driver hospitality area, and we will not be providing complimentary food for drivers. Please plan accordingly. Restrooms will be available through door 31N.

Prop Trucks and Drivers

Equipment vehicles will be directed around the East side of the building to unload at door #31N. Once unloaded, vehicles will be asked to park on the South side of the east lot close to the Activity Center. Contest officials will direct your props/tarp to our staging area where they will process in performance order and meet your guard at the performance entrance in the Northwest corner of the gym. Please leave personnel with your props/tarp to move through the performance flow.

Upon exiting the gym after performance there is a very long but narrow corridor for you to organize your equipment. Be prepared for a 90° left turn through this door.

Prop loading after performance will be at door #32E

General Info for all drivers

Everyone (even prop folks) must have an IHSCGA director lanyard or paid wristband for admission to the gym. Your director will receive those at Guard Check-in. You will need to get lanyards or wristbands from your guard's director to enter the performance gym.

These are IHSCGA Policies. Thank you.

Greenwood Winter Guard Invitational

Spectator Information

Directions to Greenwood: If you are using a GPS Device or Mapquest, the address is 615 West Smith Valley Road, Greenwood, Indiana 46142.

Spectator Parking: Band Practice Lot on the northeast side of the school.

Spectator Entrance: North Side of the school through Door #2N (Main Entrance)

Wristbands: We will be using a wristband system for admission to the gym. Your wristband is only good for admission for the block that your student is performing in. Lost wristbands will not be replaced. Spectators should not arrive more than 30 minutes before the start of their performer's block.

Admission: Admission is \$7 per person, children 5 and under are \$3, infant in lap is free. Credit/Debit Card will be the only accepted method of payment. Cash will not be accepted.

No food, drink, or coolers may be brought into the building.

All of campus is a non-smoking facility. Thank you in advance for your cooperation.

COVID Protocols for Attending this Event:

- If you are sick with a COVID related symptom(s), are undergoing evaluation by a provider for COVID-19 symptoms, or are waiting for test results, for the safety of everyone, please do not attend this competition. Assuming technology cooperates, you will be able to take advantage of our free live streaming option.
- Everyone in attendance will be required to properly wear a mask for the duration that they are in the building. Proper mask wearing includes covering of the mouth and nose.
- Please observe social distancing throughout the venue.
- Common areas will be monitored and safety protocols will be enforced.
- We will not be serving concessions. Please plan accordingly.

First Floor
Greenwood Community
High School

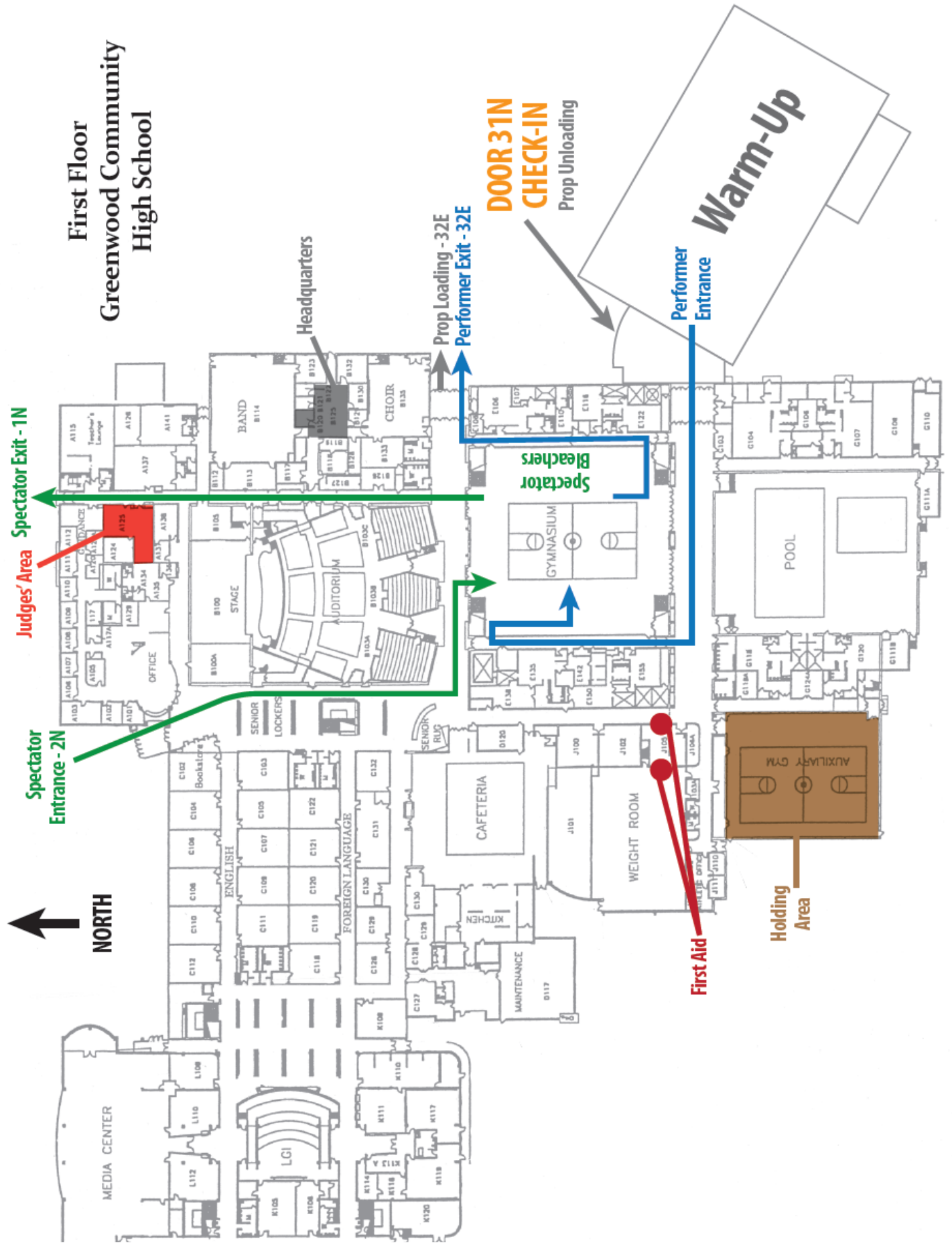

Spectator
Entrance - 2N

Judges' Area
Spectator Exit - 1N

NORTH

Headquarters

Prop Loading - 32E
Performer Exit - 32E

DOOR 31N
CHECK-IN
Prop Unloading

Spectator
Bleachers

Performer
Entrance

First Aid

Holding
Area

Warm-Up

IHSCGA Guard Contest

Greenwood Community High School

615 Smith Valley Road, Greenwood, IN 46142



Greenwood Community High School Performance Gym/Interior Layout

