



IHSCGA Contest Winter Fantasy

At Bishop Dwenger High School

1300 E Washington Center Rd, Fort Wayne, IN 46825

January 21, 2023

GUARD CHECK IN

All Buses will enter the Bishop Dwenger High School campus via the East Entrance off of North Clinton Street. **Guard Check IN will be located at the East doors, Door 1.** Make sure the director of your unit is present to identify the free admissions and check in. Extra student prop wristbands are \$3. Extra Adult prop wristbands are \$7.

BUS PARKING

Bus drivers will enter at the entrance off of E Washington Center Rd and head forward to the Guard check in area to drop off teams to Door 1. Buses will exit the Check In Area by door 1 and turn in to the parking lot on the left hand side. **Only one (1) wrist band per bus/equipment vehicle will be distributed.**

For pick up at the conclusion of the contest once your group is ready to leave your group will need to exit the building at door 1 to get to your buses. No buses will be allowed to park for pick up in the spectator or director parking areas. When busses leave the campus, they will need to leave out onto North Clinton Street.

DIRECTOR PARKING

Directors are welcome to park in front of the busses in the parking lot closest to North Clinton St.

GENERAL SPECTATOR ADMISSION

All Spectators will enter the Bishop Dwenger High School campus via the North Entrance off of East Washington Center Rd. Parking Volunteers will be on hand to help guide spectators into the parking lots. Entrance for spectators will be doors 4 and 5; also wristbands will be used. No admission to the gym without a wristband. Wristbands will also be on sale at guard check in.

HOMEROOMS

There will be spots marked off in the hallways for the guards to keep personal items. This space is only available from the time guard's check-in until they finish performing. Your space must be vacated after your group is finished performing. For the remainder of the time that your group is on campus, students are welcome to watch other guards perform in the main gym, or go to concessions. Dressing Rooms are located in the restrooms located in the hallway area designated restrooms. Units should not use the concession area restrooms as changing areas. For Security purposes please note that only individuals with Director, Performer or prop passes will be allowed into the Homeroom areas. If you have someone arriving late please meet them to get their pass at the Guard Check IN table. Spectators wishing to meet up with their student or director will need to meet in the concessions area.

GYM, TIMELINE, WARM-UP, ETC.

Please see appropriate map. If you have any questions or need assistance please do not hesitate to ask any of our workers. Inspection will be held in the hallway leading to our cardio room and the Warm-Up will be located in our SAC GYM. Performances will be held in the main GYM. The timeline will be a vertical timeline. *Please note, guides are not provided to take you to your specific destinations. Signs will be posted. Directors may want to locate destination areas before taking their guard.*

HOSPITALITY ROOM

Located in the Library. **Bus Drivers, Prop Truck Drivers, Directors, instructors only with IHSCGA Badges please** so you can have a place to relax and refuel.

PROPS

Also Entering off of the East Entrance on N Clinton St. and going straight and to the left behind the building, Prop vehicles will be Unloading at Door 12. After unloading vehicles will follow the lot to the left to park trailers and trucks. The Prop Exit after the performance will be through **Door 17** south of the school.

The smallest doorway encountered during the performance day is a doorway with a height of 6ft 4in and 4ft 6in wide. Please be prepared for this

Competition Suite

All Commentary and Videos will be provided via Competition Suite following your groups performance. WIFI access information will be available in the Directors Hospitality Area.

Critique

Critique will be held for all Classes next to the Directors Hospitality Area in room 140

Recaps, sheets, packets

Please check Competition Suite for recaps.

Contact Info

On the day of the contest please contact

Contest Director

Don Cochran

Email: dcochran@bishopdwenger.com

Cell: (260)433-2701



IHSCGA Contest Winter Fantasy

At Bishop Dwenger High School
1300 E Washington Center Rd, Fort Wayne, IN 46825

Parent & Fan Information

Spectator Parking: North of the school. The entrance is off of E. Washington Center Road.

Spectator Entrance: Doors 4 and 5 of the school.

Admission is \$7 per person, children 5 and under are \$3, infant in lap is free.

Doors for spectators will open at 11:00am.

Programs will be available electronically via QR Code.

Wristbands: we will be using wristbands as a way to enter the performance gym. Lots of wristbands will not be replaced.

We ask you to please stay seated during performances. You may leave the main gym between performances. During performance, the gym doors will be closed.

Concessions: Bishop Dwenger Performing Arts will be providing a concession stand filled with a variety of Pepsi products and water. You will also find popcorn, variety of candy, nachos, hot pretzels & cheese, and specialty items for this event. We accept cash and card.

No food or coolers may be brought into the school.
Campus is smoke free.

Thank you to all!

We want to thank you all for attending the Bishop Dwenger Winter Fantasy Guard Contest. It is very important during this time to be patient and appreciative of everyone. We have seen our youth, directors, schools, parents and fans continue to go through trying times. Let us all celebrate together by showing our appreciation after each guard has performed with applause! What a great day it is for us all to be together beaming with pride for our youth's hard work and dedication!

Congratulations to all the guard members, families, fans, directors and schools! Let's celebrate the arts!

~Bishop Dwenger Performing Arts



1st Floor

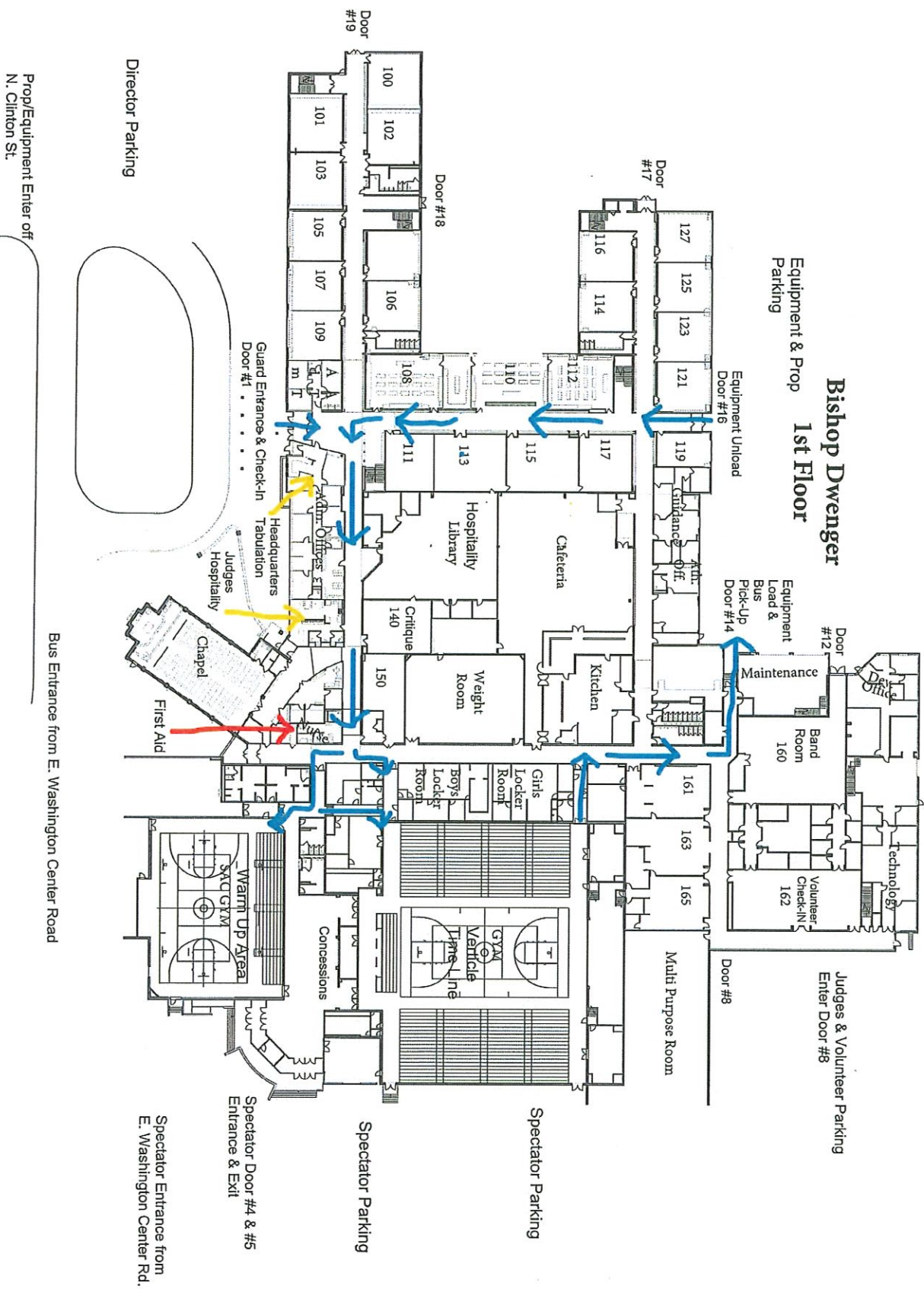

Bishop Dwenger High School

Spectators and Judges



Vertical Timeline

Guard/Prop Exit

Guard/Prop
Entrance