

# IHSCGA Contest

## Greenwood Community High School

2/10/2024

IMPORTANT - SHARE WITH YOUR PARENTS, FANS, DRIVERS:  
GPS ADDRESS IS **615 West Smith Valley Road Greenwood, Indiana 46142**

**No food or drink may be brought into the building. No coolers will be allowed.**

### **GUARD CHECK IN**

Have your bus drop students at **door #31N** on the north side of the high school (Greenwood Student Activity Complex - SAC). Make sure the director of your unit is present to identify the 8 free admissions and check in. You will also receive passes for your bus/truck drivers (one per steering wheel). Extra student prop tickets are \$3. Extra adult prop tickets are \$10.

### **BUS PARKING**

Buses will be directed to park in the band practice area lot which is north east of the school building close to the band tower.

### **Director Parking**

Director parking will be on the North side of the school.

### **GENERAL SPECTATOR ADMISSION**

- Spectator Parking - East lot in between school and football stadium.
- Spectator entrance-Door #32E - Performing Arts Entrance.
- Doors will open at 10AM.
- Admission is \$10 per person, children 5 and under are \$3. Infant on lap is free.
- Programs are free and digital. QR codes will be available the day of the event.
- There will be no admission to the gym without a wristband or ticket.

[Purchase tickets online using this link \(Click Here\).](https://ghsband.org/buy-tickets-2024-ihscga-greenwood-invitational-winter-guard-contest/)

<https://ghsband.org/buy-tickets-2024-ihscga-greenwood-invitational-winter-guard-contest/>

### **HOMEROOMS**

There will be spots marked off in the hallways for guards to keep personal items. This space is only available for the time guards are in warm-up and performing. Items need to be removed after the group is finished performing. This is not a warm-up spot. Please only use this location for storage.

### **GYM, TIMELINE, WARM-UP, ETC.**

Please see the included map. If you have any questions or need assistance, please do not hesitate to ask any of our workers.

The warm up area will be in our student activity complex. The basketball goals will be up. Groups will be allowed to use music during the second half of their warm up time per IHSCGA guidelines.

Groups will enter through the NW corner of the gym (back right from audience view). The floor will be covered with a black tarp. We will utilize a vertical (sideline to sideline) timeline. Groups will exit the gym at the SE corner (front left from audience view).

## **HOSPITALITY ROOM**

Located in the IMC - **Directors and instructors only with IHSCGA Badges please.**

**Bus drivers and prop truck drivers will have a separate hospitality room located in the teacher workroom - C132.**

## **PROPS**

Equipment vehicles will be directed around the East side of the building to unload at **door #31N**. Once unloaded, vehicles will be asked to park on the South side of the main lot close to the student activity center. Contest officials will direct your props/tarp to our staging area where they will process in performance order and meet your guard at the performance entrance in the North-West corner of the gym. Please leave personnel with your props/tarp to move through the performance flow.

Upon exiting the gym after performance there is a very long but narrow corridor for you to organize your equipment. Be prepared for a 90° left turn through this door.

Prop loading after performance will be at door #32E.

## **Door Dimensions**

**The narrowest path you will encounter will be 5 feet, 3 inches wide.**

**The shortest height you will encounter is 6 feet, 8 inches tall.**

## **Tarp Refolding Area**

There will be a limited tarp refolding area provided after the performance. This location is a long hallway.

## **Critique**

You must sign up for critique by 5:00 p.m. on 2/9/24 through your CompetitionSuite account. Critique with the Overview Judge will begin at 2:30 p.m. Critique for the remainder of the groups will begin at approximately 7:00 p.m. (after 2<sup>nd</sup> awards ceremony).

Recaps will be available on CompetitionSuite. Any other items may be picked up at contest headquarters (band office) or in hospitality (IMC).

## **Contact Information**

Contest Host - Luke Aylsworth  
812-797-5079 (cell and day of contest number)  
317-889-4000 x3136 (office)  
[jaylsworth@gws.k12.in.us](mailto:jaylsworth@gws.k12.in.us)

Music Department Secretary(Interim) - Kristen Short  
317-889-4000 x3407 (office)  
317-889-4036 (fax)  
[kshort@gws.k12.in.us](mailto:kshort@gws.k12.in.us)

# **BUS AND TRUCK DRIVER INFORMATION**

## **Bus Drivers**

Follow signage to drop students at door #31N on the north side of the high school.

Buses will be directed to park in the band practice area lot which is North East of the school building close to the band tower.

The driver rest area will be in the cafeteria.

## **Prop Trucks and Drivers**

Equipment vehicles will be directed around the East side of the building to unload at door #31N. Once unloaded, vehicles will be asked to park on the South side of the main lot close to the tennis courts/baseball diamonds. Contest officials will direct your props/tarp to our staging area where they will process in performance order and meet your guard at the performance entrance in the North West corner of the gym. Please leave personnel with your props/tarp to move through the performance flow.

Upon exiting the gym after performance there is a very long but narrow corridor for you to organize your equipment. Be prepared for a 90° left turn through this door.

Prop loading after performance will be at door #32E.

The driver rest area will be in the cafeteria

## **General Info for all Drivers**

Everyone (even prop/tarp crew) must have an IHSCGA director lanyard or paid wristband/ticket for admission to the gym. The Director / Staff Hospitality room in the IMC is for guard directors and TEACHING staff only with IHSCGA lanyards. All others will be asked to leave. These are IHSCGA Policies. Thank you!

## **Spectator Information**

- **DIRECTIONS TO GREENWOOD:** 615 West Smith Valley Road Greenwood, Indiana 46142
- **SPECTATOR PARKING & ENTRANCE:** EAST SIDE OF THE SCHOOL DOOR #32E
- **NO FOOD OR DRINK OR COOLERS MAY BE CARRIED INTO THE BUILDING.**
- **ALL OF THE CAMPUS IS A NON SMOKING FACILITY**

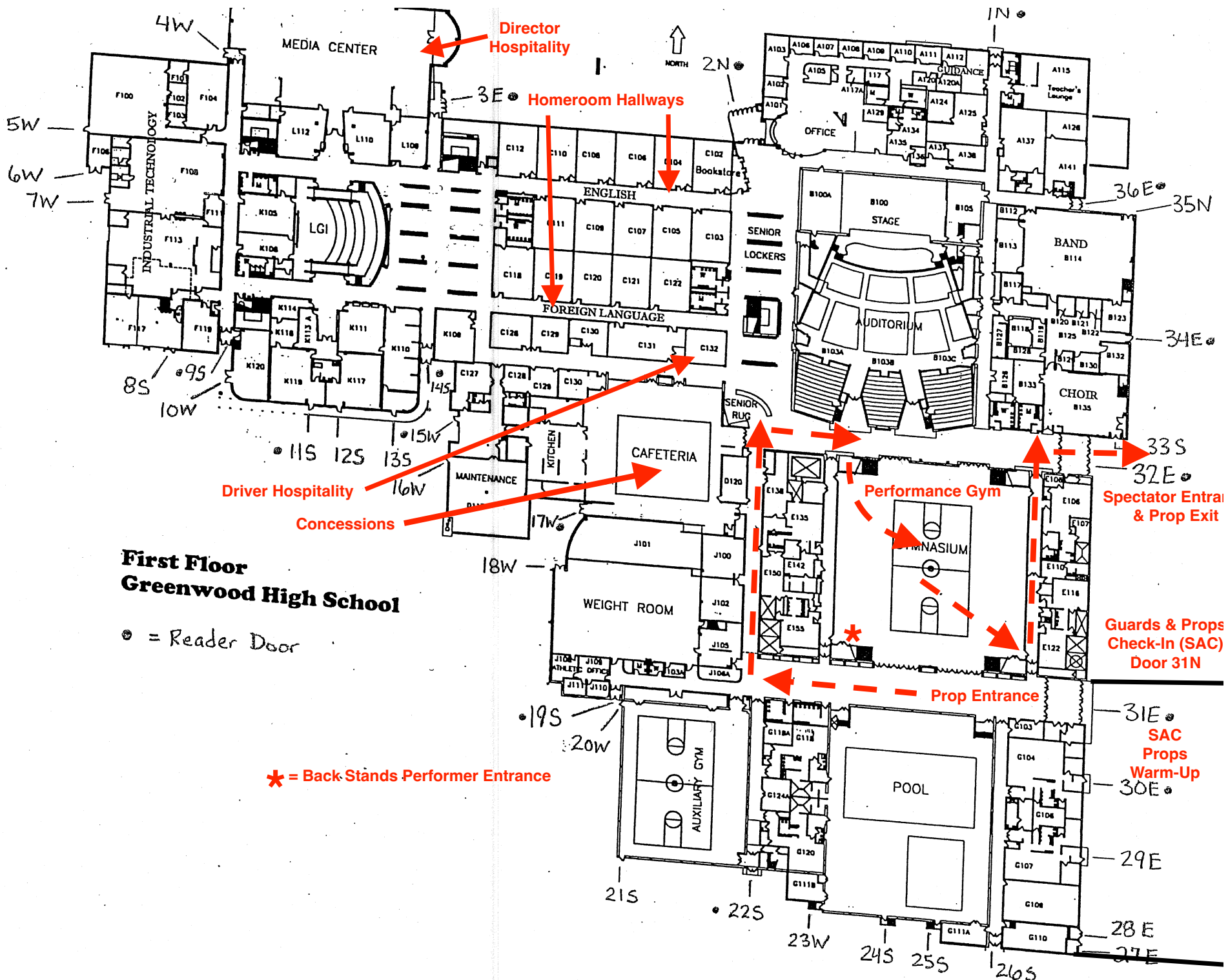

**First Floor  
Greenwood High School**

● = Reader Door

\* = Back Stands Performer Entrance

Driver Hospitality

Concessions

Director Hospitality

Homeroom Hallways

Performance Gym

Prop Entrance

Spectator Entrances & Prop Exit

Guards & Props Check-In (SAC) Door 31N

SAC Props Warm-Up

Greenwood Community High School Performance Gym/Interior Layout

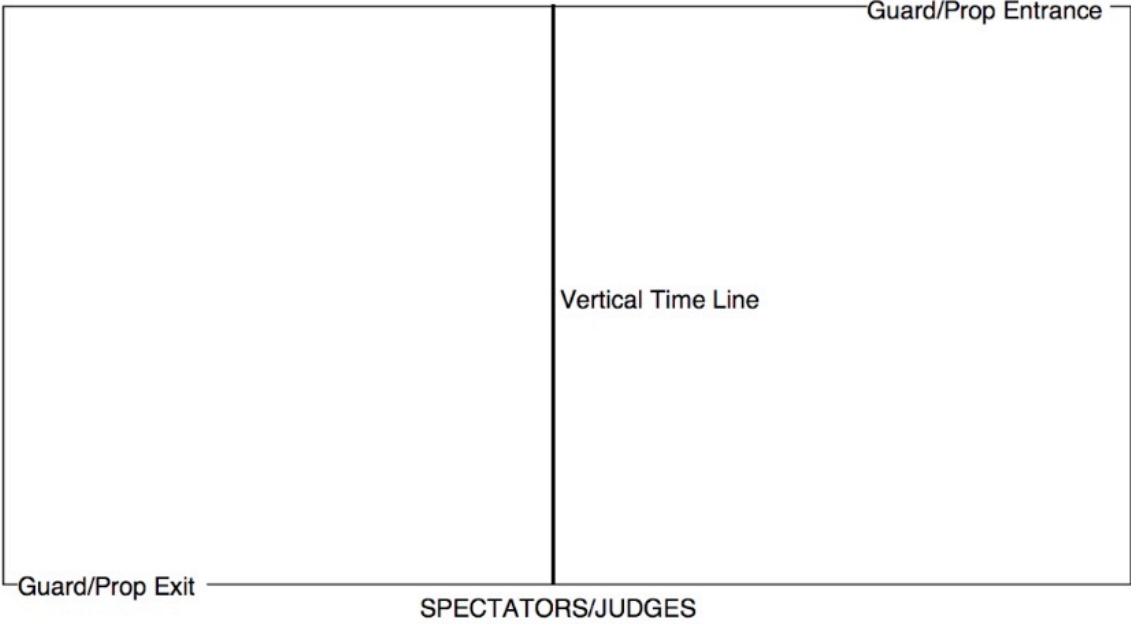

N →