

IHSCGA Contest at Hamilton Southeastern HS

March 2, 2024

**IMPORTANT - SHARE WITH YOUR PARENTS, FANS, DRIVERS:
OUR ADDRESS IS 12499 Olio Road, Fishers, IN 46037**

No food or drink may be brought into the building. No coolers will be allowed.

PLEASE REFER TO THE EXTERIOR LOGISTICS MAP

GUARD CHECK IN

Check in will be at Door 2. Buses will pull up along the curb at Door 2 and allow the guards to unload. THIS IS THE SAME GUARD CHECK-IN LOCATION AS LAST YEAR. This will allow guards to easily find and help the prop truck with unloading. From check-in, guards will be escorted to a Storage Area for their equipment.

BUS PARKING

Use Olio Road to pull into the front lot for unloading. Buses will be directed to a lane next to the curb at Door 2 to drop off their guard. After dropping off their guard they will be directed to exit the lot on the North side of the school onto 126th and circle back to the South entrance of the lot to park in the front of the school. When it is time for your guard to leave the contest, they will exit Door 1 and load the bus where it is parked. When the bus is ready to leave, they will leave via an exit lane in the parking lot to the exit on the North side onto 126th Street.

PROPS

Please note that props will enter AND exit the building at Door 2 at the front of the school on Olio Road. This enables a much smoother contest flow within the building. Trucks will be directed to a truck lane in front of Door 2 to load/unload and then proceed to truck parking as designated on map. Guard buses will be dropping off in the same location to better assist with prop unload if needed. After unloading, the truck will be directed to exit the lot on the North side of the school onto 126th Street. The trucks will then circle back onto Olio Road and utilize the South Entrance that the spectators are also using. There will be prop truck parking available on the band practice lot. Drivers can then enter the building at Door 18 or Door 2. All other prop personnel should park in Spectator Parking.

DIRECTOR PARKING

Director parking will be in the parking lot at the front of the school off Olio Rd near the guard check-in entrance. Look for the Buses/Trucks signs. We are asking all directors to park in the spots along the curb closest to Olio Road.

GENERAL SPECTATOR ADMISSION

- Spectator Parking is located on the South side of the school and the entrance is off of Olio Road. Look for Royalty Drive.
- Spectators will enter Door 18.
- Spectator wristbands will be distributed just inside the entrance.
- The performance gym is a bit of a walk from Door 18, please allow 5-10 extra minutes for getting to the gym. If you have someone requiring handicap accessibility, please email Audrey Torres at atorres@hse.k12.in.us

Cash or Credit Card will be accepted at the door.

No admission to the gym without a wristband.

Admission: \$10.00

Children 5 and under \$3.00

Infant in Lap - Free

HOMEROOMS

IHSCGA has eliminated the use of homeroom areas. Guards will be provided a space in classroom hallways to store their equipment. HSE is not responsible for any lost or stolen items, so please do not leave valuables in the storage area. Restrooms will be available. Glitter application is prohibited inside the building.

FIRST AID

First Aid will be located just outside the performer entrance/exit to the Main Performance Gym. There will also be a basic First Aid kit available in warm up if needed. Please see contest volunteers for assistance in getting to First Aid if necessary.

CONCESSIONS

The concession stand is located right outside the main performance gym. We will be serving a full menu of meal items, snacks, and drinks. Concessions will accept cash or credit card.

GYM, TIMELINE, WARM-UP, ETC.

Please see appropriate map. If you have any questions or need assistance, please do not hesitate to ask any of our workers.

The warm-up area will be in our auxiliary gym that is split into an A and B warm up location. The goals will be up. Groups will be allowed to use music during the second half of their warm-up time per IHSCGA guidelines.

Groups will enter the performance gym through the upper right corner. The floor will be covered with a black tarp. We will utilize a HORIZONTAL timeline. Groups will exit the gym through the lower right corner.

HOSPITALITY ROOM

Director Hospitality will be located in Cafeteria D just a little outside the flow of the main performance gym. See map. **Directors and instructors only with IHSCGA Badges will be allowed into this area.** Director Hospitality will be available in Cafeteria D.

Driver Hospitality will be located in Cafeteria C, a partitioned portion of the large Cafeteria, across from Director Hospitality. Everyone must have the proper credentials to enter this area.

Contact Information

Contest Host-Audrey Torres

317-997-8293 (cell and day of contest number)
atorres@hse.k12.in.us

Ed Roush 720-838-4467

BUS AND TRUCK DRIVER INFORMATION

Bus Drivers..

Buses will turn off of Olio Road to access Door 2. Buses will be directed to a lane next to the curb at Door 2 to drop off their guard. You will be given a wristband and map at this time. After dropping off the guard you will be directed to exit the lot on the North side of the school onto 126th and circle back to the South entrance of the lot to park in the front of the school. You may then enter either Door 1 or Door 2. When it is time for your guard to leave the contest, they will exit Door 1 and load the bus where it is parked. When the bus is ready to leave, you will leave via an exit lane in the parking lot to the exit on the North side of the school onto 126th Street.

Hospitality will be located in Cafeteria C. You must have a wristband for entrance into this area.

Prop Trucks and Drivers

Props will enter AND exit the building at Door 2 at the front of the school on Olio Road. Trucks will be directed to a truck lane in front of Door 2 to load/unload and then proceed to truck parking as designated on map. You will be given a wristband and map as you unload. After unloading, you will be directed to exit the lot on the North side of the school onto 126th Street. You will then circle back onto Olio Road and utilize the South Entrance that the spectators are also using. There will be prop truck parking available on the band practice lot. Look for the semi-trailers. You can then enter the building at Door 18 or Door 2.

Hospitality will be located in Cafeteria C. You must have a wristband for entrance into this area.

General Info for all drivers

Everyone (even prop personnel) must have an IHSCGA director lanyard or paid wristband for admission to the gym.

The Director / Staff Hospitality room in Cafeteria D is for guard directors and TEACHING staff only with IHSCGA lanyards. All others will be asked to leave. These are IHSCGA Policies. Thank you.

Hamilton Southeastern Guard Show

FAN / PARENT INFORMATION

DIRECTORS, ENSURE YOUR FAMILIES RECEIVE THIS INFORMATION

- **DIRECTIONS TO HAMILTON SOUTHEASTERN:** IF YOU ARE USING A GPS DEVICE OR MAPQUEST.....USE 12499 Olio Road, Fishers, IN 46037
- **SPECTATOR PARKING:** SOUTH OF THE SCHOOL OFF OF OLIO RD.
- **SPECTATOR ENTRANCE:** SOUTH SIDE OF THE SCHOOL **DOOR #18** The performance gym is a bit of a walk from Door 18, please allow 5-10 extra minutes for getting to the gym. If you have someone requiring handicap accessibility, please email Audrey Torres at atorres@hse.k12.in.us
- **WRISTBANDS:** WE WILL BE USING A WRISTBAND SYSTEM FOR ADMISSION TO THE GYM. Lost wristbands will not be replaced. Spectator wristbands will be distributed just inside Door 18.
- Cash or Credit Card will be accepted at the door.
- No admission to the gym without a wristband.
- **Admission: \$10.00 Children 5 and under: \$3.00 Infant in Lap: Free**

- **NO FOOD OR DRINK OR COOLERS MAY BE CARRIED INTO THE BUILDING.**

- **ALL OF THE CAMPUS IS A NON-SMOKING FACILITY**

- **CONCESSION STAND IS LOCATED RIGHT OUTSIDE THE MAIN PERFORMANCE GYM NEAR THE SPECTATOR ENTRANCE**

The concession stand is located right outside the main performance gym near the spectator entrance. We will be serving a full menu of meal items, snacks, and drinks. Concessions will accept cash or credit card.



IHSCGA Competition - March 2, 2024

Interior Logistics



126th St.

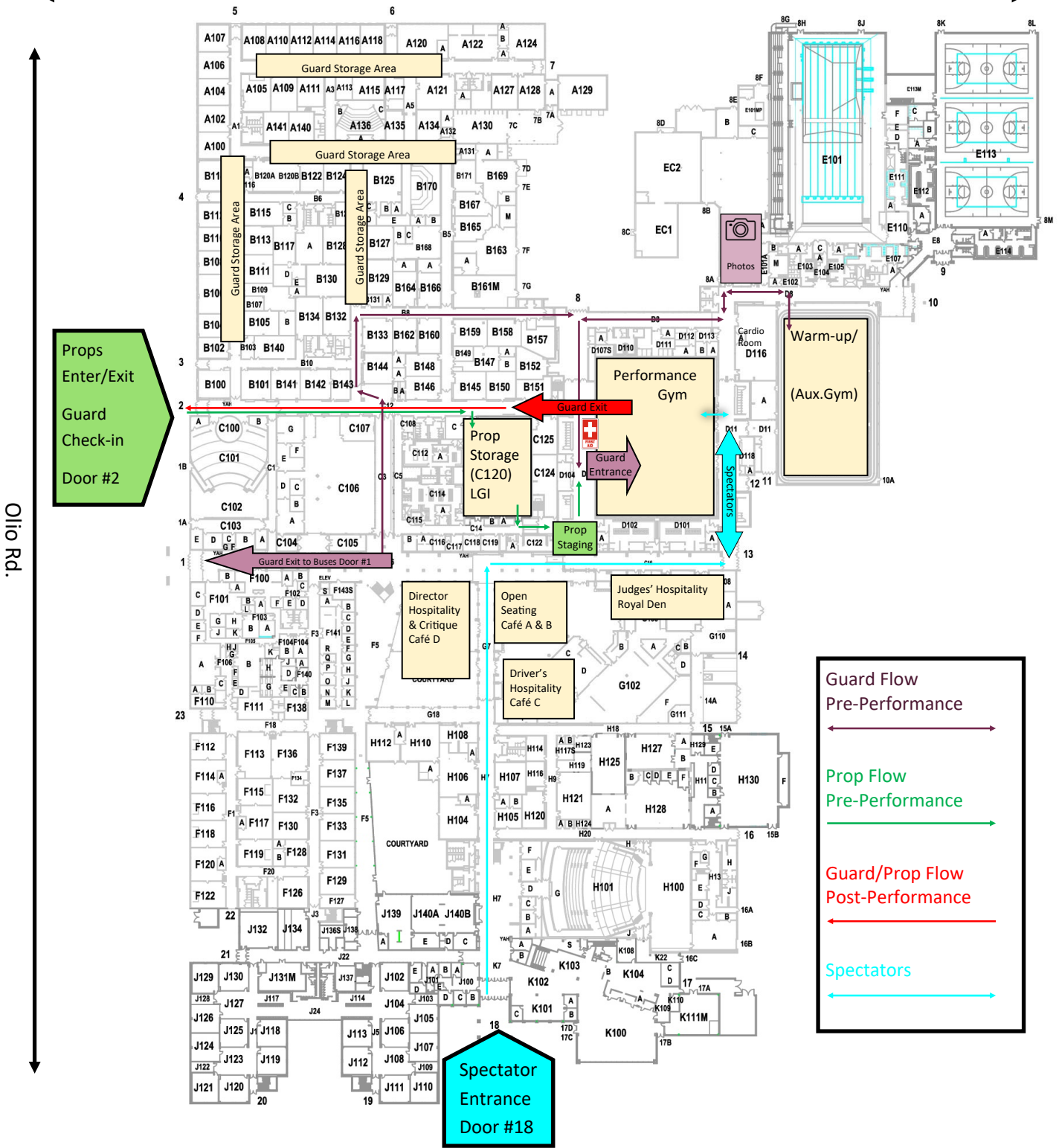

Props
Enter/Exit
Guard
Check-in
Door #2

Ohio Rd.

Guard Flow
Pre-Performance

Prop Flow
Pre-Performance

Guard/Prop Flow
Post-Performance

Spectators

Spectator
Entrance
Door #18



Hamilton Southeastern High School
12499 Ohio Rd., Fishers, IN 46037
Main Office 317-594-4190



IHSCGA Competition - March 2, 2024

Exterior Logistics

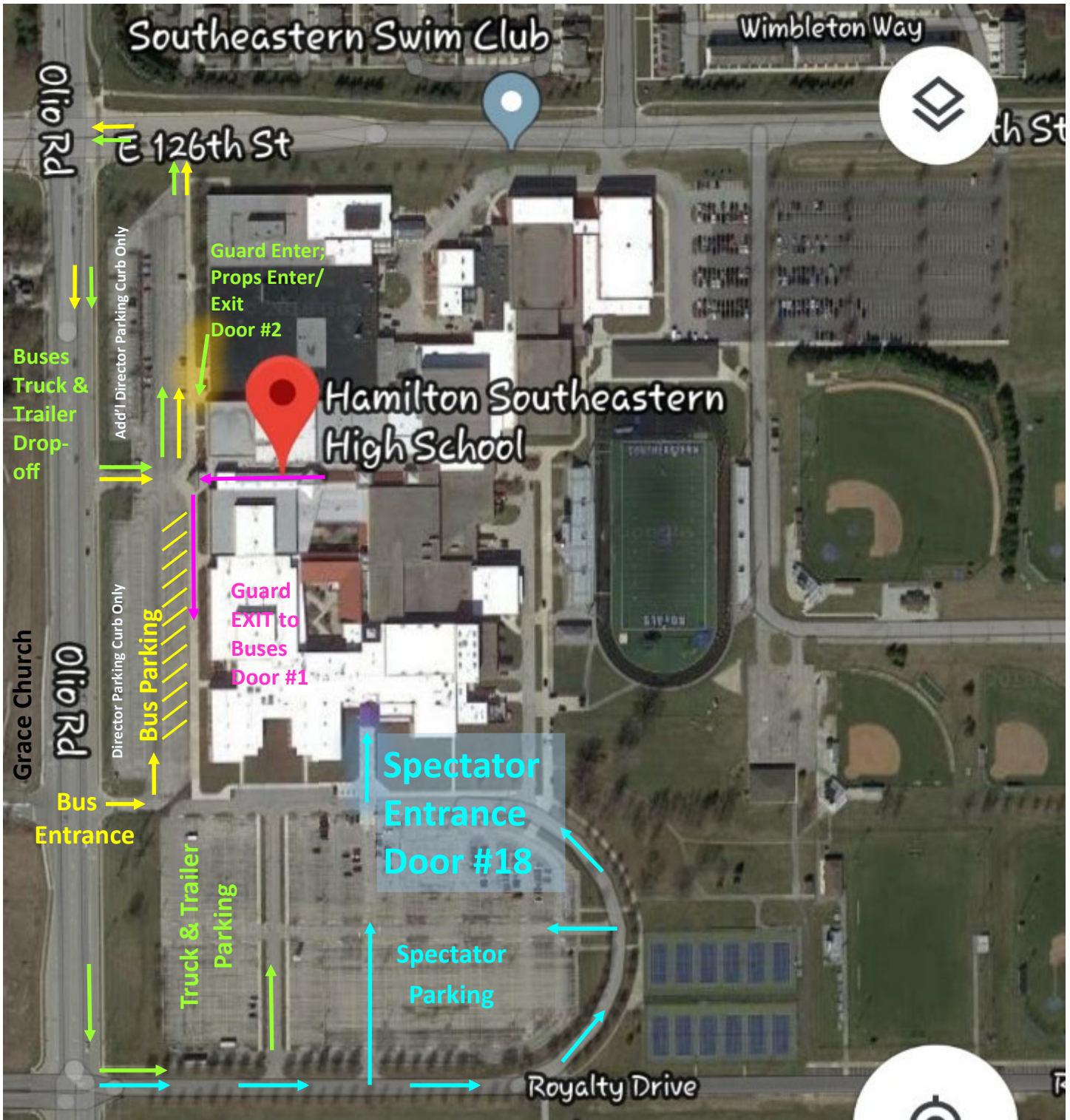

Hamilton Southeastern High School
12499 Olivo Rd., Fishers, IN 46037
Main Office 317-594-4190

Back Side Seating

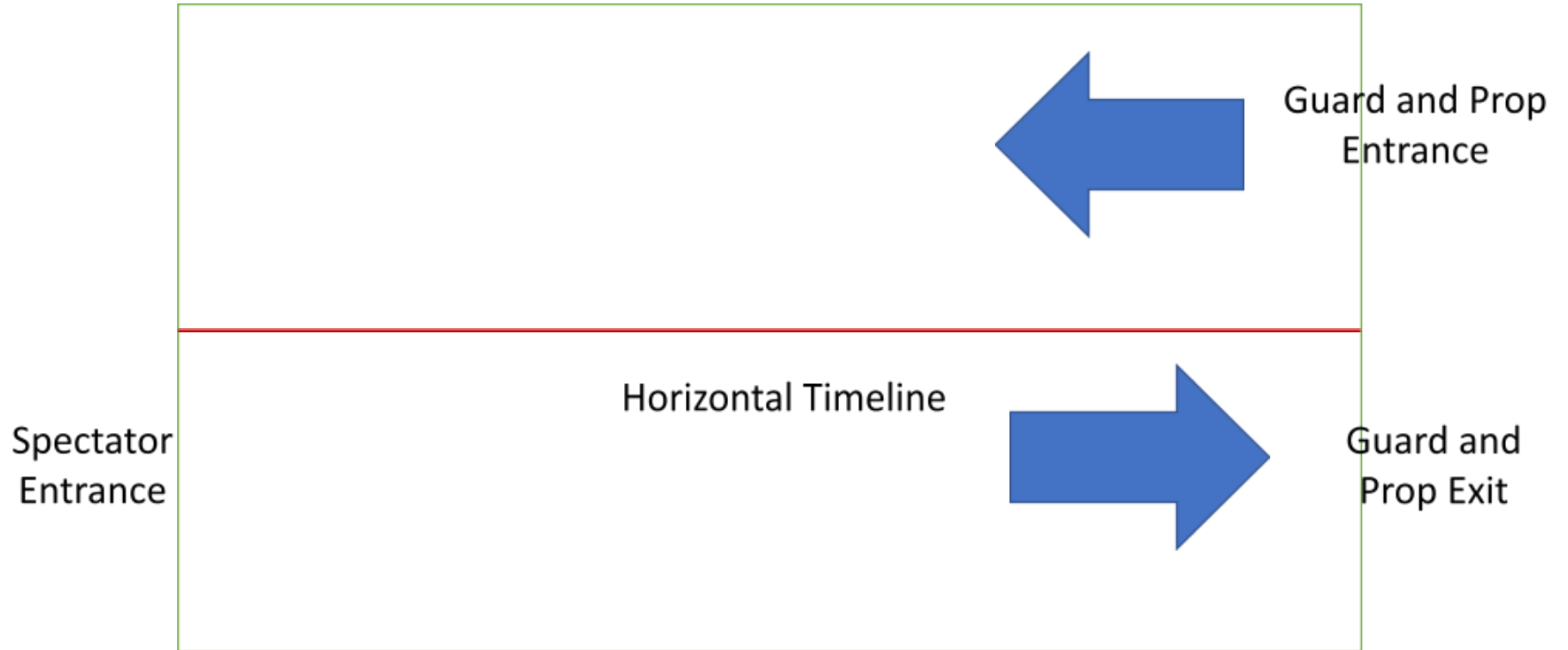

Front Side Seating