

North Side High School

Winter Guard Contest

Saturday, February 1, 2025

North Side High School, 475 E. State Blvd, Fort Wayne IN 46805

GUARD CHECK IN

Use DOOR 16 Entrance. For Reference: You will drop off your unit off at Door 16 on North Side Drive highlighted in **neon green** on the aerial view map provided. Make sure the director of your unit is present to identify the 8 backside seating admissions and check in. You will also receive 2 frontside passes and meal tickets for your bus/truck drivers (one per steering wheel). Directors should make sure passes/meal tickets are given to drivers BEFORE drivers proceed to prop entrance or parking. Extra backside seating tickets are \$3. Extra frontside tickets are \$10.

Nurses First Aid for Performers

There will be two Nurses available in the Athletic Office as soon as you exit the Main Gym after your performance look for the first door on your right. If your student performers need attention there will be Nurses in there to assist them.

Police Officer

We will have a police officer on campus during our event.

BUS PARKING

Buses will be on North Side Drive in the back of the school. Buses will drop their units off at door 16 on North Side then proceed to park on the same street.

Director's Restrooms

We will have staff restrooms open and marked in the commons specifically for Guard Staff to have a private restroom. These restrooms are located between the Aux Gym Warm Up Entrance and the Cafeteria. These are single-occupancy restrooms.

Director Parking

Directors will park in the lot near the football stadium on the corner of Nettie Avenue and Eade Avenue. See map provided for location.

Cafeteria Tables

There will be tables marked off in our Cafeteria for guards to keep personal items. This space will be available 1 hour before your transit time and must be vacated within 1 hour after your group is finished performing. For the remainder of time that your group is on our campus, students are welcome to utilize backside seating, vendor and concessions areas outside the gym. Please keep all food and drinks in the gymnasium or commons. Dressing Rooms are located in the following areas: The locker rooms located off of K Hall in our tunnel to the football stadium. See indoor map for location. Girls Performer Restroom (K Hall Restroom across from the cafeteria). Boys Performer Restroom (K Hall Restroom across from the cafeteria).

NO GLITTER IS TO BE APPLIED IN NORTH SIDE HIGH SCHOOL. Please apply hairspray only in bathroom.

HOSPITALITY ROOMS

Located in the Teachers Lounge Room H120 directly passed the cafeteria. **Directors and instructors only with IHSCGA Badges PLEASE!** Bus driver and prop truck driver hospitality is located in the driver hospitality room A-249 This room is located on the 2nd Floor around the circle.

North Side High School

Winter Guard Contest

Saturday, February 1, 2025

North Side High School, 475 E. State Blvd, Fort Wayne IN 46805

GYM. TIMELINE. WARM-UP. ETC.

Please see appropriate map. If you have any questions or need assistance please do not hesitate to ask any of our workers.

Warm-Up- (Auxiliary Gym). Groups will be allowed to use music during the second half of their warm up time per IHSCGA guidelines.

Performance Venue- (Main Gym) We utilize a vertical timeline. Groups will enter from the SW corner of the gym. Groups will exit the gym at the SE corner

GENERAL SPECTATOR ADMISSION

Spectators should park in the Main Parking Lot and enter the building via Door 1.

All Fort Wayne Community Schools utilize an open gate weapons detection system that all spectators will pass through.

Doors will open to Spectators one hour before the first group's performance time.

Admission is \$10 per person, children 5 and under are \$3, infant in lap is free

Programs will be available via hard copy.

Wristbands will be used. No admission to the gym without a wristband. Wristbands will also be sold at guard check in.

PROPS

Equipment vehicles will follow buses down Nettie Ave turn right on Eade Ave, left on Stadium Ave, and left on North Side Drive. You will drop off props at Door 22 and park on North Side Drive near your prop drop off. You will get your tickets at Door 16 where the guard check in is which is right next to door 22.

Look for Door 22 on North Side Drive which is the loading dock. Unload your large equipment using the garage door at the loading dock at Door 22.

Props enter the building through (DOOR 22). This route is represented by the [neon green line on the outdoor map.](#)

Please park your equipment truck with your buses on North Side Drive.

Awards/Recaps/Critique

Critique will take place in the Gear Up Office G106

Recaps, Commentary, and Video will be available via Competition Suite.

Aaron King
School 260-467-2800
Cell / Text 260-705-5464
Aaron.King@fwcs.k12.in.us



North Side GUARD SHOW

BUS AND TRUCK DRIVER INFORMATION

Bus Drivers..

BUS PARKING

You will drop your students off at Door 16 in the back of the school on North Side Drive. You will park your bus on this same street (North Side Drive) as your student drop off.

Bus driver and prop truck **driver hospitality** is located in the driver hospitality room **A-249** This room is located on the 2nd Floor around the circle.

Prop Trucks and Drivers

Driver wristbands and meal tickets will be given to Guard Directors upon checking in. One pass per steering wheel up to 2 per group (1 bus/1 equip truck). Do not drive away from door 16 without your wristband and meal ticket!

PROPS

Will drop off at the loading dock which is Door 22 on North Side Drive. You will then park your vehicle on North Side Drive behind your bus.

Get your wristbands/meal tickets at Door 16.

General Info for all drivers

Everyone (even prop folks) must have an IHSCGA director lanyard or paid wristband for admission to the gym.

The Director / Staff Hospitality room in the Media Center is for guard directors and TEACHING staff only with IHSCGA lanyards. All others will be asked to leave.

The driver hospitality room A-249

These are IHSCGA Policies. Thank you.

North Side WINTER GUARD CONTEST

PARENT INFORMATIONAL HANDOUT

Directors: Please distribute this page to parents.

SCHOOL ADDRESS 475 E. State Blvd, Fort Wayne, IN 46805

SPECTATOR PARKING In the main lot outside Door 1 and the student lot located behind El Azteca Restaurant,

SPECTATOR ENTRANCE Door 1. All spectators will pass through an open gate detection system.

WRISTBANDS We will be using a wristband system for admission.

SCHEDULE: You can visit <http://www.ihscga.org> and click on *Events* and then click on *North Side Contest* to find the Logistical Schedule for our show.

NO FOOD OR DRINK OR COOLERS MAY BE CARRIED INTO THE BUILDING.

(This includes DoorDash, Uber Eats, or any other food delivery services.) Please share this message with students, staff, and chaperones to avoid any awkward situations with the volunteers that are required to enforce this policy.

ALL OF THE CAMPUS IS A NON SMOKING FACILITY.

CONCESSIONS will be available for purchase! We will be serving a full menu at reasonable cost for you to take advantage of. We appreciate your support!

NORTH SIDE GYM DIAGRAM

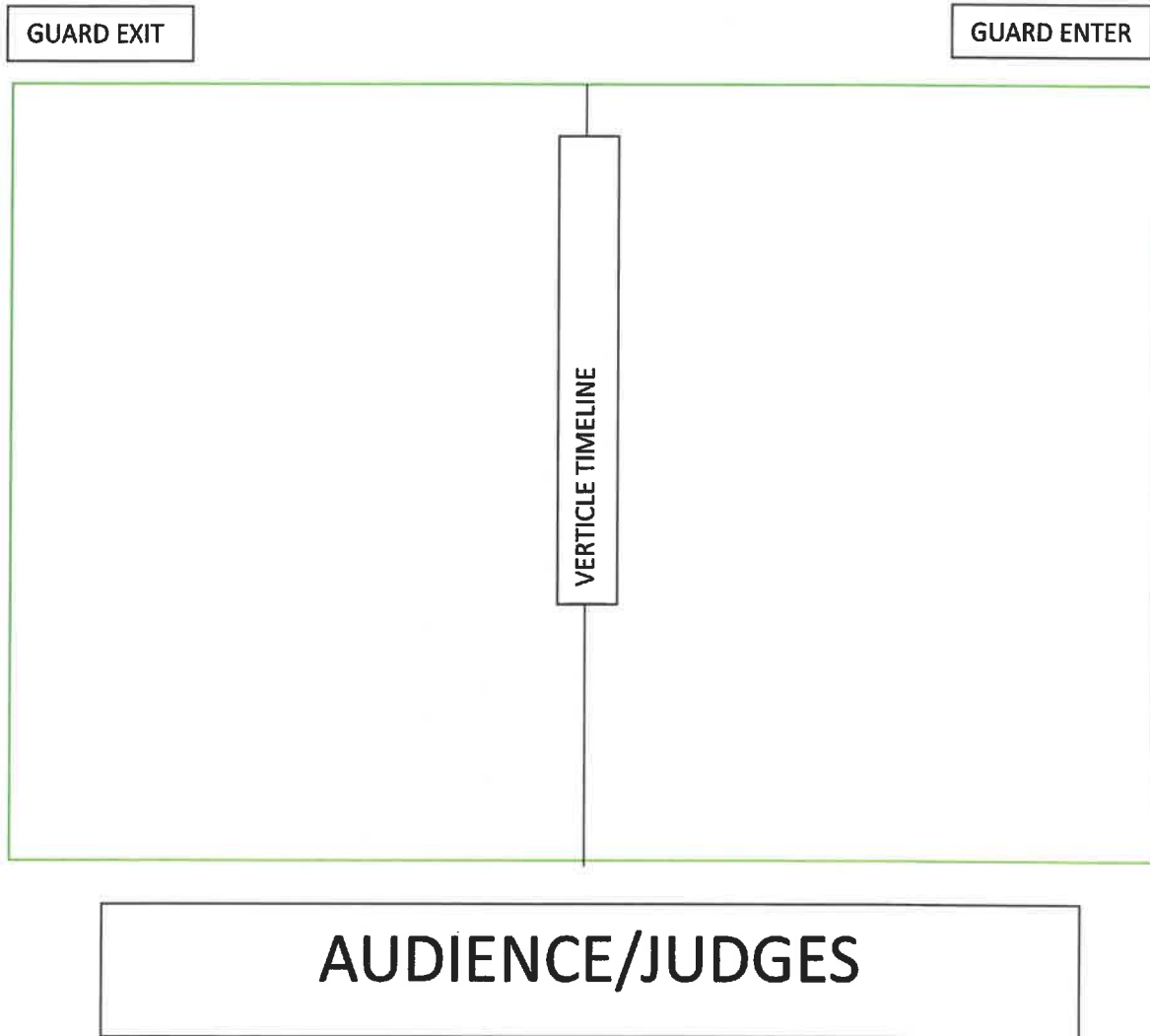

NETTIE AVENUE

PLEASANT AVENUE

EAST STATE BOULEVARD

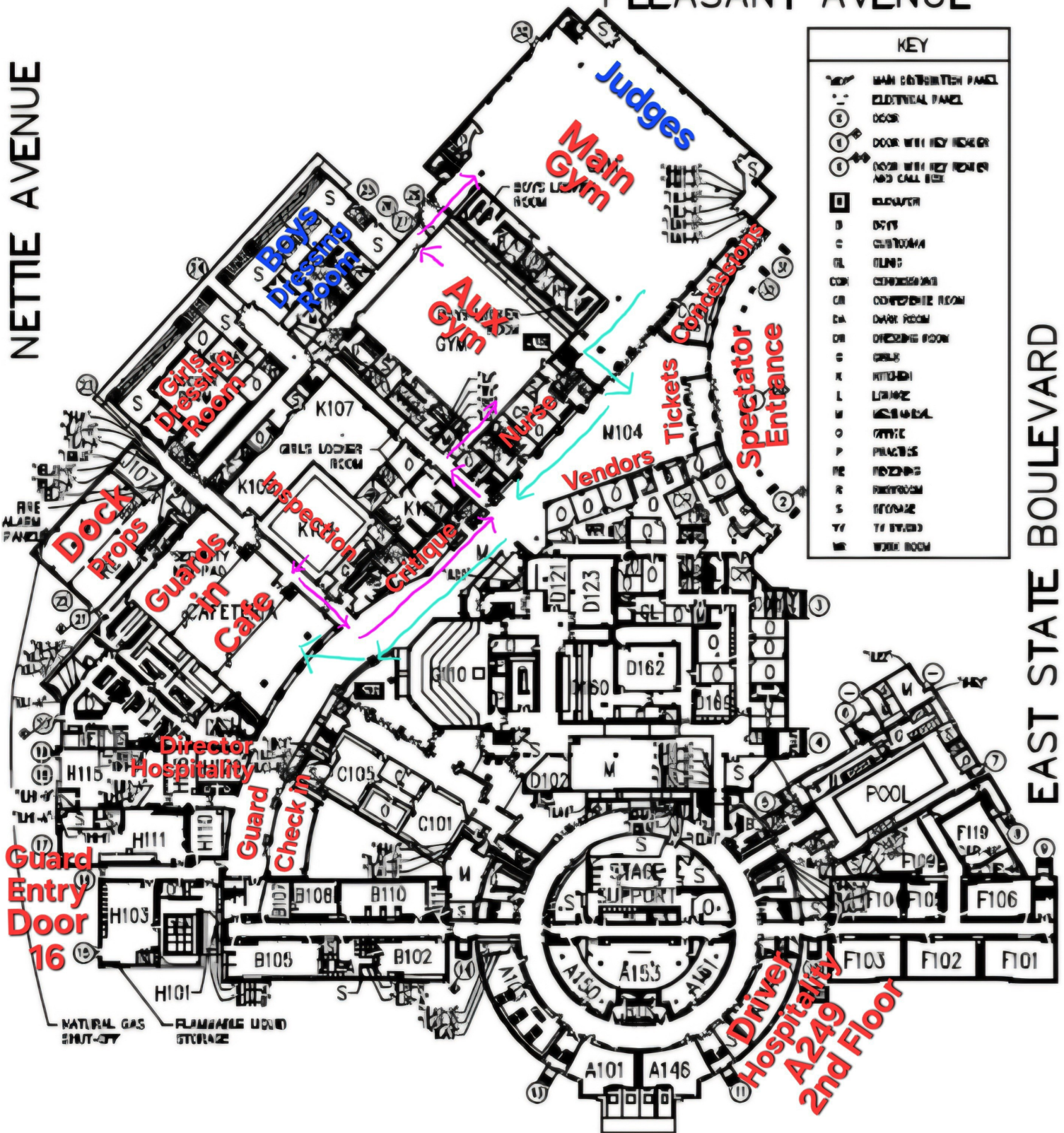



North Side Bands Concession Menu

Hot dog \$3

- w/ chili or cheese \$3.25
- w/ both \$3.50

Walking Taco \$3.00

Nachos w/ cheese \$4.50

Nachos w/ chili and cheese \$5.00

Popcorn \$2.00

Cookies \$2.00

Pretzel \$4.00

- w/ cheese \$4.50

Deluxe Nachos \$8.00

Hot Dog w/ chips & drink \$6.00

BBQ pork sandwich w/ chips & drink \$8.00

Cheesecake \$3.00

Water \$2.00

Gatorade \$3.00

Soda \$3.00



North Side



Winter Guard Show

Saturday February 1, 2025

12:00pm-6:00pm

Admission \$10



475 E. State Blvd.
Fort Wayne, Indiana 46805
Phone: 260-467-2800