

**Welcome to the
IHSCGA @ Zionsville Community HS**

**Zionsville Community High School
1000 Mulberry Street
Zionsville, IN 46077
Saturday, March 1, 2025**

**We are pleased to have you at this competition.
Enjoy your participation in this event!**

In order to have a SAFE and Enjoyable experience for all,

PLEASE READ THIS PACKET CAREFULLY

If you have any questions, please don't hesitate to contact us:

Host On-site Managers:

Tom Landrum tlandrum@zcs.k12.in.us 317-797-1642

Jeff King jeking@zcs.k12.in.us 317-403-7473

IHSCGA On-site Rep: Kim Wilhoit 765-749-6373

Thanks, Good Luck and Have a Great Day!



**2025 IHSCGA
@ Zionsville Community HS**



IHSCGA @ Zionsville Community HS

Saturday, March 1, 2025

IMPORTANT - SHARE WITH YOUR PARENTS, FANS, DRIVERS:

OUR ADDRESS IS 1000 Mulberry Street, Zionsville, IN 46077

PLEASE READ THIS PACKET CAREFULLY

Important Information for All Guards:

- Check-in for Guards and Props is no earlier than **60 minutes** prior to your first transit time.
- Guard and Prop Check-in will take place at Door 17.
- Guards have **60 minutes** after your performance to remove belongings from your Hallroom and take them back to your bus. Please do not be late vacating that area as the space will be needed for another group.
- Critique:

Critique for Cadet, Festival and Reg A Rounds 1 & 2 with the Overview Judge will take place approximately 4:15. That will take place in Hospitality.

Critique for all other groups will take place immediately after the last performance at approximately 9:00. This will also take place in hospitality.

Remember, you will need to sign up for critique in advance in Competition Suite.

IHSCGA @ Zionsville Community HS

GUARD INFORMATION

Guard Check-in

- Check in is at Door 17 on the west end of the south side of the building.
- Check in will occur no sooner than **60 minutes** prior to your first transit time.
- The director will receive Yellow wristbands for your declared number of performers, 8 Yellow wristbands for Prop personnel and 2 Black wristbands for drivers.
- Staff with IHSCGA badges will not need wristbands. All other personnel **MUST** have a wristband to gain access to the performance gym.
- If you need additional Yellow wristbands for prop personnel, they are \$3 and must be purchased at Guard Check-in. Cash or credit - \$3.00
- Please note Yellow wristbands for Performers and Prop personnel are backside seating only. If you want front side seating, you will need to purchase a Black & White wristband at Guard Check-in or at admissions inside Door 3. Cash or credit - \$10.00

Bus & Prop Truck Entrance & Parking

- BUS & PROP TRUCKS will enter the campus from the farthest north entrance on the west end of the south side of the building from Hal Sharpe Road and proceed to Guard and Prop Check-in at Door 17. After unloading at Check-in, your bus will proceed to the lot immediately west of the football stadium to park. They will hold there until time to reload.
- Upon completion of their performance, Guards will return to their Hallroom on the West end of the building to retrieve their belongings, change and then take them to their bus outside Door 17. Props will immediately proceed to Door 17 for reloading.

There is no parking or pickup on the north side of the school.

Director Parking

Directors may park in any space in the South Lots. There is no parking on the north side of the building.

Hallroom Areas

- Upon check-in, you will be led to a Hallroom area for you to leave your items while you go through your rotation.
- Restrooms will be available near your holding area. These can be used for changing clothes.
- After your performance, you will need to immediately return to your Hallroom, collect your belongings, change, if you choose to and vacate the space. You have **60 minutes** from the end of your performance to vacate the space.
- Belongings should be taken to your bus outside Door 17.

Inspection

Please make sure all equipment and props are properly taped and padded. Equipment inspection will take place in the Fieldhouse prior to your warmup time. Prop inspection will take place upon Check-in.

Warm-up

- Warm-up is located in the fieldhouse.
- You will have a full-size court for your warm-up with curtains dividing the courts.
- There will be a clock on your court running a countdown so you know at all times where you are in your warm-up time.
- As in the past, you will be allowed to use music in the second half of your warm-up time.
- We will have a sound system available for you to use to connect via Bluetooth.
- You can bring your own sound system but volume will be controlled at the discretion of the Warmup Area Lead. Please cooperate with this.
- Upon completion of warm-up, you will be directed to the performance holding area where you will meet up with your props.

Performance Gym. Sound Check & Exit

- Performance gym layout (Please see map provided)
 - We will utilize a vertical timeline.
 - You will enter back Side 2 and exit front Side 1.
 - Power will be available center front and back should you need it.
- Sound Checks
 - Sound checks may be done during breaks.
 - Please make sure your music is uploaded into Competition Suite prior to the event.

- Performance Gym Exit
 - You will snake your tarp out of the gym. Be prepared for a sharp right turn as you exit the gym.
 - Upon exit there is a long hallway for you to use to put your tarp back on your cart. We do not have a tarp refolding area.
 - Once that is complete, the guard and props will proceed to Door 17 to hallroom & reload.
 - To avoid congestion, please push props out to trucks and load trucks where they are parked. There should be plenty of room. If weather is an issue, we will adapt as needed.

Hospitality Room

- Hospitality will be located in the Band room.
- This will be for directors and instructors **only** with IHSCGA Badges and Drivers with black wristbands.
- Please be respectful of this requirement.

Critique.

- Critique for Cadet, Festival and Reg A Rounds 1 & 2 with the Overview Judge will take place at approximately 4:15. That will take place in Hospitality.
- Critique for all other groups will take place immediately after the last performance at approximately 9:00. This will also take place in hospitality.
- Reminder: You must sign up for Critique on Competition Suite.

Please note: There is no guest wifi available in the building. We are reserving the bandwidth for judge commentary and video transfer. Thanks for your understanding.

IHSCGA @ Zionsville Community HS

BUS AND TRUCK DRIVER INFORMATION

Bus Drivers (Please see map provided):

Buses should enter from Hal Sharpe Road on the west side at the farthest north entrance on the south side of the school. You will proceed to Door 17 where you will be directed where to drop students off.

After unloading you will be directed to the lot immediately west of the football stadium.

Your director will receive a Black wristband that gets you into Hospitality.

Prop Trucks and Drivers (Please see map provided):

Prop Trucks should enter from Hal Sharpe Road on the west side at the farthest north entrance on the south side of the school. You will proceed to Door 17 where you will be directed to where to unload..

After unloading you will be directed to the lot immediately west of the football stadium.

Your director will receive a Black wristband that gets you into Hospitality.

Please see the map provided to help you.

Once inside, contest officials will direct your props/tarp to the staging area where they will be placed in performance order and will flow to meet your guard at the performance entrance in the northwest corner of the gym. Please leave personnel with your props/tarp throughout to move through the performance flow.

Props will load out at Door 17.

General Info for all drivers:

Everyone **MUST** have an IHSCGA director lanyard, Yellow (backside seating only), Black or Black/White Check wristband for admission to the gym. Your director will receive the Yellow (backside seating only) and Black wristbands at Guard Check-in. You will need to get them from them to enter the performance gym. These are IHSCGA Policies. Thank you!

Black/White Check wristbands can be purchased at admissions inside Door 3.

There will be no equipment vehicle parking or reloading on the north side of the school.

Please note: There is no guest wifi available in the building. We are reserving the bandwidth for judge commentary and video transfer. Thanks for your understanding.

IHSCGA @ Zionsville Community HS

SPECTATOR INFORMATION

Address for Zionsville High School:

Zionsville Community High School 1000 Mulberry Street Zionsville, IN 46077

Event Spectator Parking and Entrance (Please see map provided):

- Spectators will enter campus to park from Hal Sharpe Road on the west end of the campus. Please plan to use the entrance just north of the Football Field to access the spectator parking lot.
- Spectator parking is located on the south side of the school between the building and the football field.
- **Spectators for this event will enter the building using Door 3.**

There is another event scheduled in the Performing Arts Center the day of the contest using Door 1 as their entrance.

Please do not park on the north side of the building. Thank you.

Ticketing: IMPORTANT PLEASE READ

- Tickets will only be sold the day of the event at the admission table inside Door 3.
- We will be taking Cash and Credit.
- Tickets will be priced as follows per IHSCGA Guidelines:
 - Adults, Seniors & Students - \$10.00
 - Children under 5 - \$3.00
 - Infant in lap - Free.
 - Principals admitted free with IASP Credential
- Entry and Ticket/Seating Procedure
 - Once you have paid, you will receive a Black/White Check Wristband. You will need this on your wrist for admittance into the seating area.
 - Handicap seating will enter at floor level.

Please note: There is no guest wifi available in the building. We are reserving the bandwidth for judge commentary and video transfer. Thanks for your understanding.

Have a great day!

2025 IHSCGA @ Zionsville Community HS - Exterior Campus Map

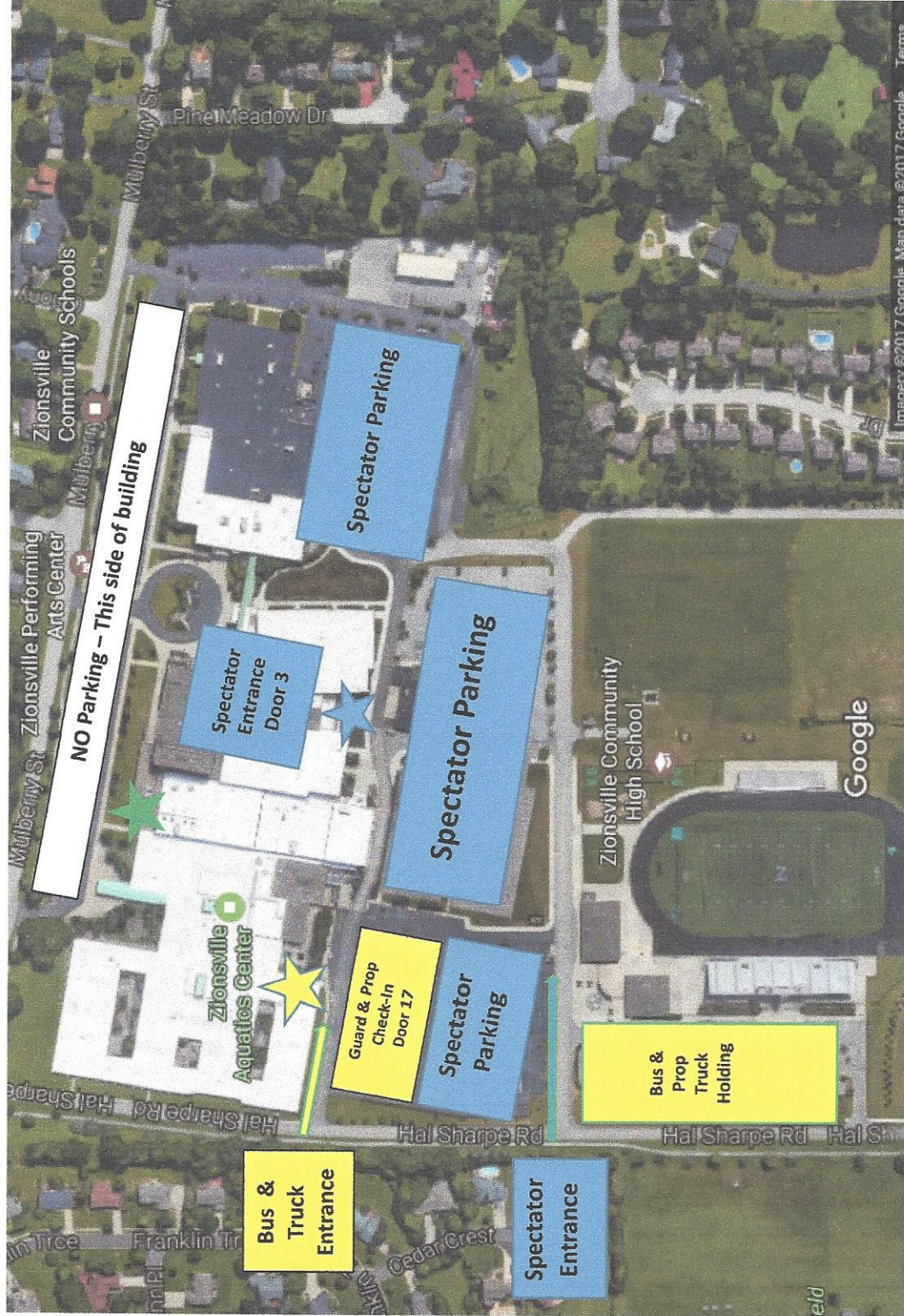

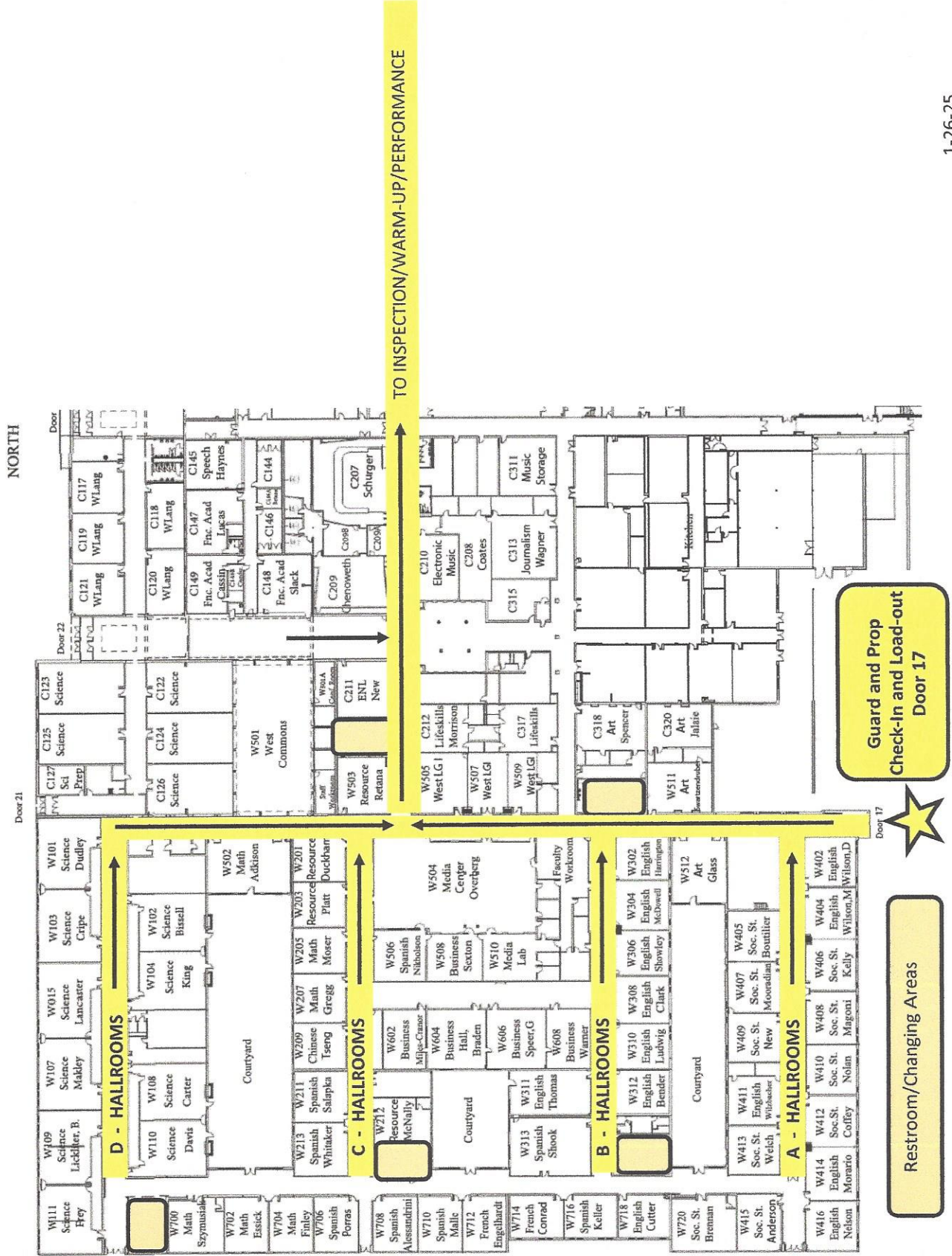

2025 IHSCGA @ Zionsville Community HS - Flow from Hallrooms to Inspection - Warmup - Performance—Load-Out

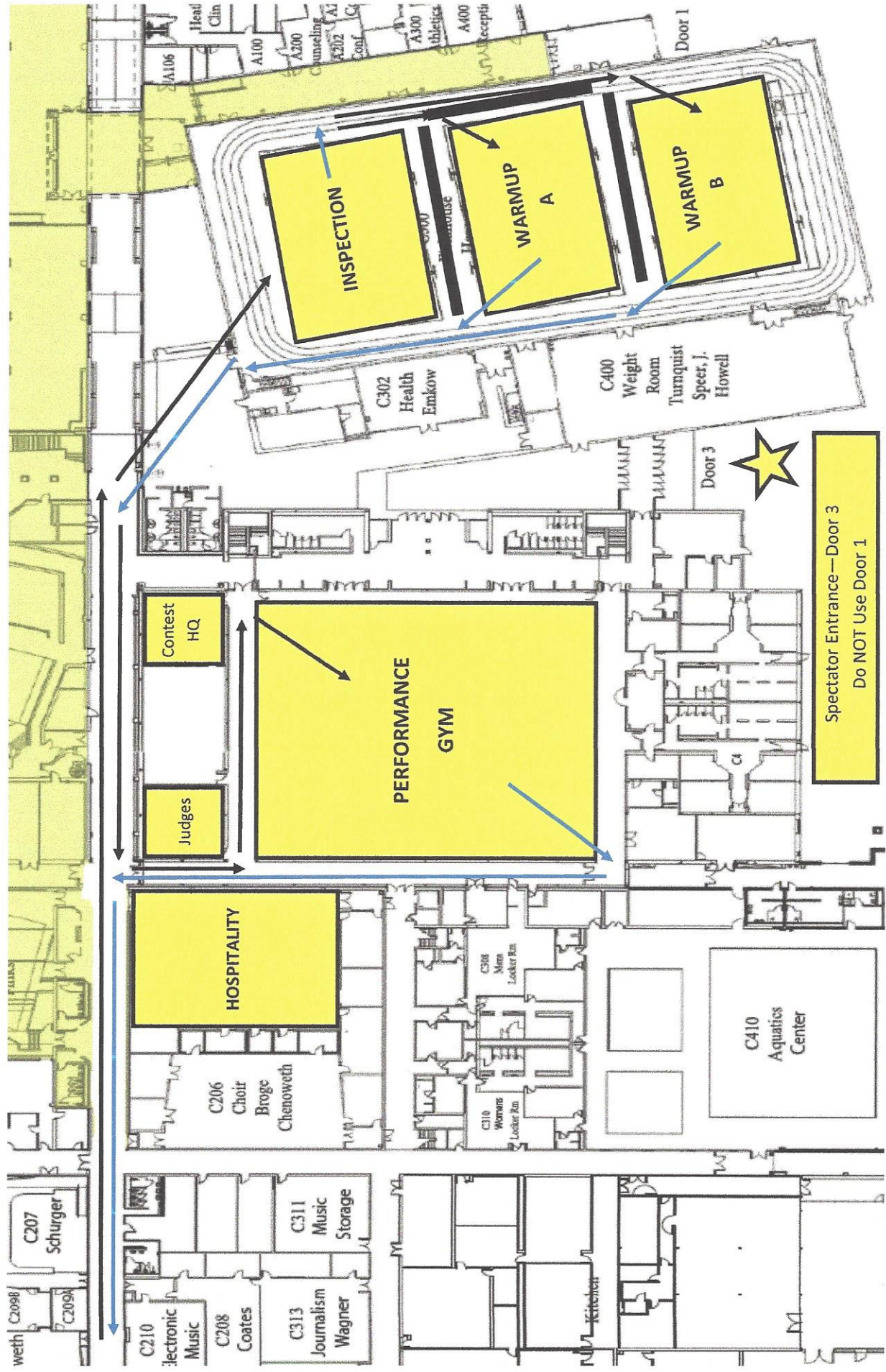

2025 IHSCGA @ Zionsville Community HS Performance Gym Flow

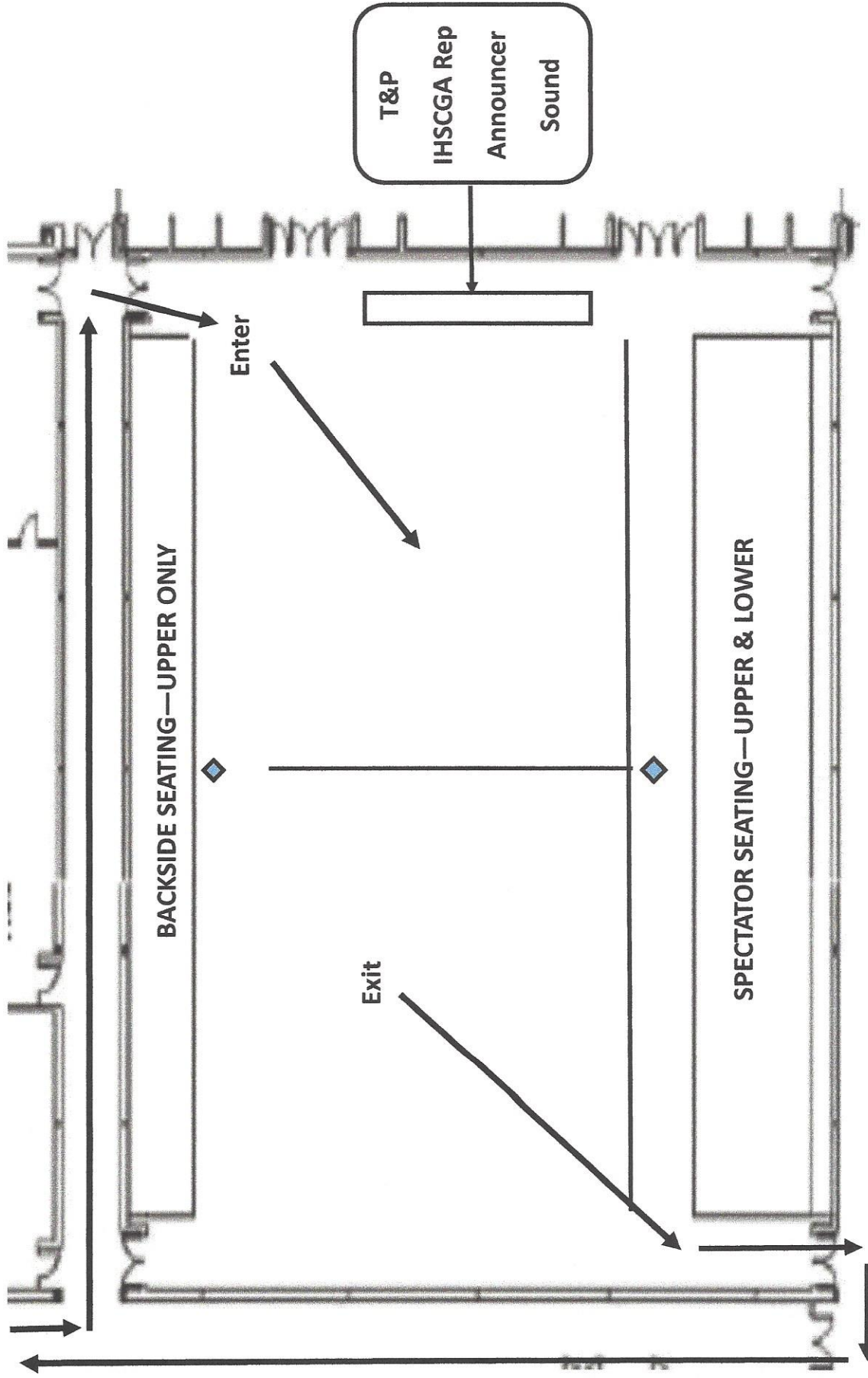

VERTICAL TIMELINE